

SUNCOR STAINLESS, INC.

# TURNBUCKLES

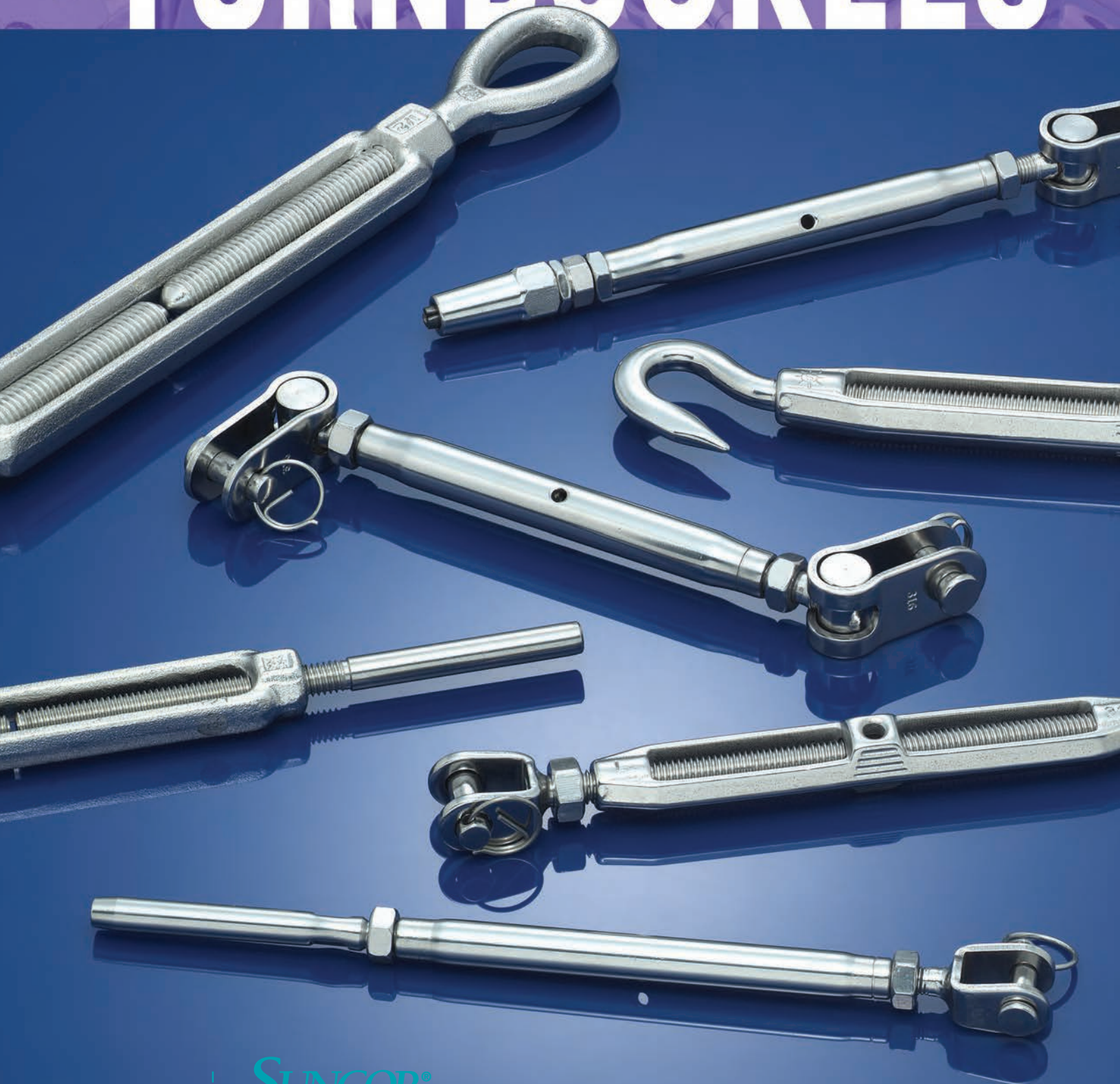

## TURNBUCKLE JAW & JAW 316-NM STAINLESS STEEL

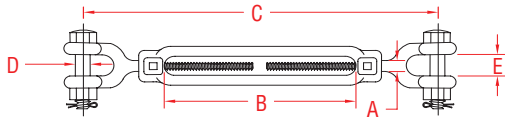
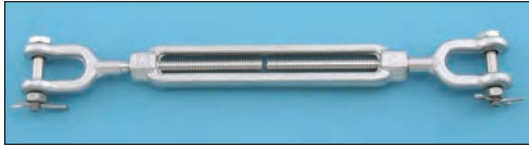

ITEM	A	B	C	D	E	WLL	WT
	(size)	(adjustment)				(lb)	(lb)
S0108-JJ07	1/4"	4.00"	7.75"	0.25"	0.44"	500	0.45
S0108-JJ08	5/16"	4.50"	9.00"	0.25"	0.50"	800	0.65
S0108-JJ10	3/8"	6.00"	10.63"	0.31"	0.56"	1,200	0.90
S0108-JJ13	1/2"	6.00"	12.00"	0.38"	0.63"	2,200	1.60
S0108-JJ16	5/8"	6.00"	13.50"	0.50"	0.75"	3,500	3.05
S0108-JJ20	3/4"	6.00"	15.00"	0.63"	1.00"	5,200	4.25
S0108-JJ25	1"	6.00"	18.00"	0.88"	1.25"	8,000	10.59
S0108-JJ25-1	1"	12.00"	24.00"	0.88"	1.25"	8,000	12.66
S0108-JJ32-1*	1-1/4"	12.00"	26.63"	1.13"	1.88"	12,500	22.32
S0108-JJ38-1*	1-1/2"	12.00"	28.95"	1.36"	2.19"	17,000	31.04

**NOTE: MEETS WLL AND DIMENSIONS OF ASTM SPECIFICATION F1145-05 (2011) TYPE 1, CLASS G. MEETS ASME B30.26-2010 SECTION 26-2.0. \*JAWS FOR SIZES -JJ32-1 & -JJ38-1, FEATURE A ROUND PIN W/ COTTER.**

## TURNBUCKLE JAW & EYE 316-NM STAINLESS STEEL

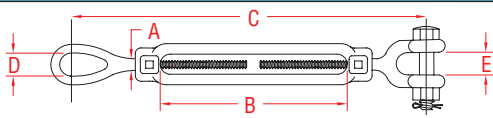

ITEM	A	B	C	D	E	WLL	WT
	(size)	(adjustment)				(lb)	(lb)
S0109-JE07	1/4"	4.00"	7.88"	0.33"	0.44"	500	0.35
S0109-JE08	5/16"	4.50"	9.25"	0.41"	0.50"	800	0.60
S0109-JE10	3/8"	6.00"	11.00"	0.50"	0.56"	1,200	0.80
S0109-JE13	1/2"	6.00"	12.50"	0.75"	0.63"	2,200	1.55
S0109-JE16	5/8"	6.00"	14.00"	0.87"	0.75"	3,500	2.69
S0109-JE20	3/4"	6.00"	15.63"	1.00"	1.00"	5,200	4.00
S0109-JE25	1"	6.00"	19.00"	1.38"	1.25"	8,000	9.66
S0109-JE25-1	1"	12.00"	25.00"	1.38"	1.25"	8,000	11.79
S0109-JE32-1*	1-1/4"	12.00"	27.50"	1.71"	1.88"	12,500	19.96

**NOTE: MEETS WLL AND DIMENSIONS OF ASTM SPECIFICATION F1145-05 (2011) TYPE 1, CLASS H. MEETS ASME B30.26-2010 SECTION 26-2.0. \*JAW FOR SIZE -JE32-1, FEATURES A ROUND PIN W/ COTTER.**

## TURNBUCKLE EYE & EYE 316-NM STAINLESS STEEL

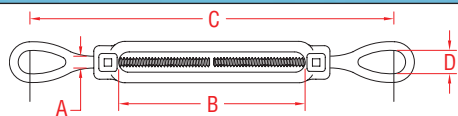

ITEM	A	B	C	D	WLL	WT
	(size)	(adjustment)			(lb)	(lb)
S0107-EE07	1/4"	4.00"	8.00"	0.33"	500	0.30
S0107-EE08	5/16"	4.50"	9.25"	0.41"	800	0.50
S0107-EE10	3/8"	6.00"	11.50"	0.50"	1,200	0.85
S0107-EE13	1/2"	6.00"	13.00"	0.75"	2,200	1.30
S0107-EE16	5/8"	6.00"	14.50"	0.87"	3,500	2.30
S0107-EE20	3/4"	6.00"	16.25"	1.00"	5,200	3.50
S0107-EE25	1"	6.00"	20.00"	1.38"	8,000	8.85
S0107-EE25-1	1"	12.00"	25.50"	1.38"	8,000	10.91
S0107-EE32-1	1-1/4"	12.00"	28.38"	1.71"	12,500	17.60

**NOTE: MEETS WLL AND DIMENSIONS OF ASTM SPECIFICATION F1145-05 (2011) TYPE 1, CLASS D. MEETS ASME B30.26-2010 SECTION 26-2.0. BODIES ONLY ON PAGE 24: S0106-BD SERIES. NUTS ARE AVAILABLE (PAGE 100), BUT SOLD SEPARATELY.**

## TURNBUCKLE HOOK & EYE 316-NM STAINLESS STEEL

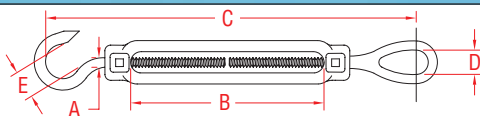

ITEM	A	B	C	D	E	WLL	WT
	(size)	(adjustment)				(lb)	(lb)
S0110-HE07	1/4"	4.00"	7.50"	0.33"	0.39"	300	0.25
S0110-HE08	5/16"	4.50"	8.50"	0.41"	0.44"	500	0.45
S0110-HE10	3/8"	6.00"	10.75"	0.51"	0.52"	750	0.67
S0110-HE13	1/2"	6.00"	12.00"	0.75"	0.55"	1,050	1.20
S0110-HE16	5/8"	6.00"	13.50"	0.87"	0.57"	1,600	2.10
S0110-HE20	3/4"	6.00"	15.50"	1.00"	0.90"	2,000	3.00

**NOTE: MEETS WLL AND DIMENSIONS OF ASTM SPECIFICATION F1145-05 (2011) TYPE 1, CLASS F. MEETS ASME B30.26-2010 SECTION 26-2.0. BODIES AND EYES ARE FORGED. HOOKS ARE FORMED AND COLD FORGED. BODIES ONLY ON PAGE 24: S0106-BD SERIES. NUTS ARE AVAILABLE (PAGE 100), BUT SOLD SEPARATELY.**

## TURNBUCKLE HOOK & HOOK 316-NM STAINLESS STEEL

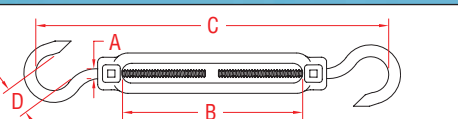
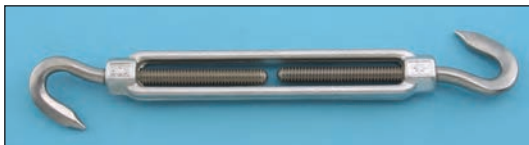

ITEM	A	B	C	D	WLL	WT
	(size)	(adjustment)			(lb)	(lb)
S0111-HH07	1/4"	4.00"	6.87"	0.39"	300	0.22
S0111-HH08	5/16"	4.50"	7.75"	0.44"	500	0.35
S0111-HH10	3/8"	6.00"	10.37"	0.52"	750	0.60
S0111-HH13	1/2"	6.00"	10.50"	0.55"	1,050	1.10
S0111-HH16	5/8"	6.00"	14.25"	0.57"	1,600	1.90
S0111-HH20	3/4"	6.00"	14.25"	0.90"	2,000	2.75

**NOTE: MEETS WLL AND DIMENSIONS OF ASTM SPECIFICATION F1145-05 (2011) TYPE 1, CLASS E. BODIES AND EYES ARE FORGED. HOOKS ARE FORMED AND COLD FORGED. MEETS ASME B30.26-2010 SECTION 26-2.0. BODIES ONLY ON PAGE 24: S0106-BD SERIES. NUTS ARE AVAILABLE (PAGE 100), BUT SOLD SEPARATELY.**

**LIMITED LIFETIME WARRANTY**

**SUNCOR STAINLESS®**

TEL 508-732-9191 • FAX 508-732-9798 • ORDERS ONLY 800-394-2222

www.suncorstainless.com

# TURNBUCKLES

TURNBUCKLES

## TURNBUCKLE STUB & STUB

316-NM STAINLESS STEEL

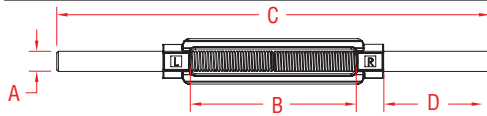

ITEM	A	B	C	D	WLL	WT
	(size)	(adjustment)			(lb)	(lb)
S0112-SS07	1/4"	4.00"	9.00"	2.00"	500	0.27
S0112-SS08	5/16"	4.50"	10.50"	2.50"	800	0.67
S0112-SS10	3/8"	6.00"	13.00"	2.85"	1,200	0.72
S0112-SS13	1/2"	6.00"	14.13"	3.30"	2,200	1.23
S0112-SS16	5/8"	6.00"	15.00"	3.38"	3,500	2.25
S0112-SS20	3/4"	6.00"	16.00"	3.85"	5,200	3.19
S0112-SS25	1"	6.00"	18.00"	4.65"	8,000	6.32
S0112-SS25-1	1"	12.00"	24.38"	4.65"	8,000	10.43
S0112-SS32-1	1-1/4"	12.00"	26.00"	4.90"	12,500	14.75

**NOTE:**  
MEETS WLL AND DIMENSIONS OF ASTM SPECIFICATION F1145-05 (2011) TYPE 1, CLASS C. BODIES ONLY ON PAGE 24. NUTS ARE AVAILABLE (PAGE 100), BUT SOLD SEPARATELY.

## TURNBUCKLE FULL THREAD

316-NM STAINLESS STEEL

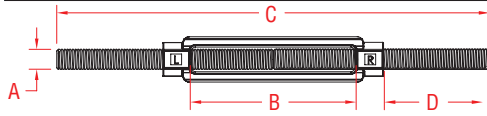

ITEM	A	B	C	D	WLL	WT
	(size)	(adjustment)			(lb)	(lb)
S0112-TS07	1/4"	4.00"	9.00"	2.00"	500	0.26
S0112-TS08	5/16"	4.50"	10.50"	2.25"	800	0.64
S0112-TS10	3/8"	6.00"	13.00"	2.88"	1,200	0.68
S0112-TS13	1/2"	6.00"	14.00"	3.00"	2,200	1.17
S0112-TS16	5/8"	6.00"	15.00"	3.25"	3,500	2.14
S0112-TS20	3/4"	6.00"	16.00"	3.50"	5,200	3.03
S0112-TS25	1"	6.00"	18.00"	4.00"	8,000	6.00

**NOTE:**  
MEETS WLL AND DIMENSIONS OF ASTM SPECIFICATION F1145-05 (2011) TYPE 1. BODIES ONLY ON PAGE 24. NUTS ARE AVAILABLE (PAGE 100), BUT SOLD SEPARATELY.

## TURNBUCKLE OPEN JAW & JAW

316 STAINLESS STEEL

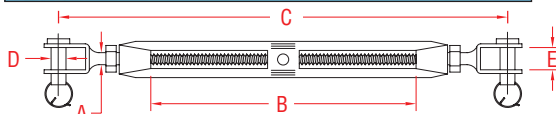

ITEM	A	B	C	D	E	WLL	WT
	(size)	(adjustment)				(lb)	(lb)
S0105-0005	3/16"	2.50"	4.81"	0.18"	0.30"	300	0.12
S0105-0007	1/4"	3.00"	5.75"	0.22"	0.38"	440	0.23
S0105-0008	5/16"	4.00"	7.12"	0.30"	0.40"	800	0.38
S0105-0010	3/8"	6.00"	10.00"	0.37"	0.46"	1,200	0.81
S0105-0013	1/2"	6.00"	11.00"	0.46"	0.59"	2,200	1.44
S0105-0016	5/8"	8.00"	14.50"	0.63"	0.69"	2,800	3.03
S0105-0020	3/4"	10.00"	18.00"	0.73"	0.76"	3,500	5.04

**NOTE:**  
ECONOMICAL, YET HIGH QUALITY TURNBUCKLE WITH PRECISION CAST BODY. JAWS ARE FORMED AND WELDED. BODIES ONLY ON PAGE 24. THREADS ARE STANDARD "UNC".

## TURNBUCKLE JAW & EYE

316 STAINLESS STEEL

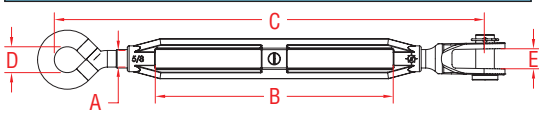

ITEM	A	B	C	D	E	WLL	WT
	(size)	(adjustment)				(lb)	(lb)
S0154-JE05	3/16"	2.50"	5.12"	0.38"	0.30"	300	0.07
S0154-JE07	1/4"	3.00"	5.87"	0.44"	0.38"	440	0.17
S0154-JE08	5/16"	4.00"	7.12"	0.50"	0.44"	800	0.32
S0154-JE10	3/8"	6.00"	10.25"	0.65"	0.50"	1,200	0.66
S0154-JE13	1/2"	6.00"	11.62"	0.75"	0.63"	2,200	1.26
S0154-JE16	5/8"	8.00"	14.50"	0.87"	0.63"	2,800	2.30
S0154-JE20	3/4"	10.00"	17.00"	1.10"	0.85"	3,500	3.85

**NOTE:**  
ECONOMICAL, YET HIGH QUALITY TURNBUCKLE WITH PRECISION CAST BODY. JAW AND EYE ARE FORMED AND WELDED. THREADS ARE STANDARD "UNC". BODIES ONLY ON PAGE 24. NUTS ARE AVAILABLE (PAGE 100), BUT SOLD SEPARATELY.

## TURNBUCKLE EYE & EYE

316 STAINLESS STEEL

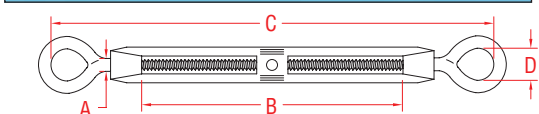

ITEM	A	B	C	D	WLL	WT
	(size)	(adjustment)			(lb)	(lb)
S0154-EE05	3/16"	2.50"	5.19"	0.38"	300	0.08
S0154-EE07	1/4"	3.00"	5.90"	0.44"	440	0.18
S0154-EE08	5/16"	4.00"	7.00"	0.50"	800	0.33
S0154-EE10	3/8"	6.00"	10.25"	0.65"	1,200	0.68
S0154-EE13	1/2"	6.00"	10.81"	0.75"	2,200	1.31
S0154-EE16	5/8"	8.00"	14.32"	0.87"	2,800	2.40
S0154-EE20	3/4"	10.00"	17.31"	1.10"	3,500	4.33

**NOTE:**  
ECONOMICAL, YET HIGH QUALITY TURNBUCKLE WITH PRECISION CAST BODY. EYES ARE FORMED AND WELDED. THREADS ARE STANDARD "UNC". BODIES ONLY ON PAGE 24. NUTS ARE AVAILABLE (PAGE 100), BUT SOLD SEPARATELY.



Key:

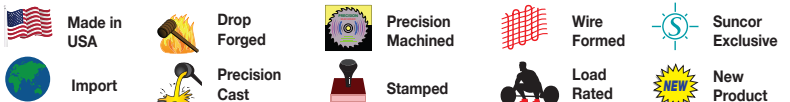

ORDERS ONLY: 800-394-2222 (USA+CANADA)

All logos, icons, images, measurements and descriptions are the sole property of Suncor Stainless, Inc. © 2020 Suncor Stainless, Inc.

## TURNBUCKLE HOOK & EYE 316 STAINLESS STEEL

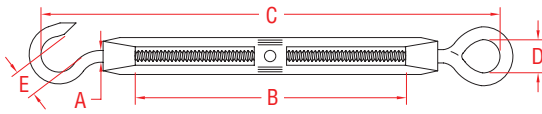

ITEM	A (size)	B (adjustment)	C	D	E	WLL (lb)	WT (lb)
S0154-HE05	3/16"	2.50"	5.12"	0.38"	0.30"	100	0.08
S0154-HE07	1/4"	3.00"	5.87"	0.44"	0.38"	200	0.18
S0154-HE08	5/16"	4.00"	7.12"	0.50"	0.44"	400	0.33
S0154-HE10	3/8"	6.00"	10.25"	0.65"	0.50"	700	0.68
S0154-HE13	1/2"	6.00"	11.62"	0.75"	0.63"	1,000	1.31
S0154-HE16	5/8"	8.00"	14.50"	0.87"	0.63"	1,600	2.40
S0154-HE20	3/4"	10.00"	17.00"	1.10"	0.85"	2,000	4.33

**NOTE:**  
ECONOMICAL, YET HIGH QUALITY TURNBUCKLE WITH PRECISION CAST BODY. EYES ARE FORMED AND WELDED. THREADS ARE STANDARD "UNC". BODIES ONLY ON PAGE 24. NUTS ARE AVAILABLE (PAGE 100), BUT SOLD SEPARATELY.

## TURNBUCKLE HOOK & HOOK 316 STAINLESS STEEL

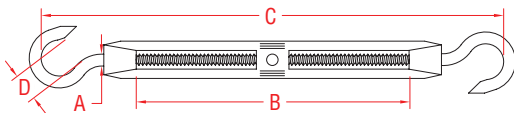
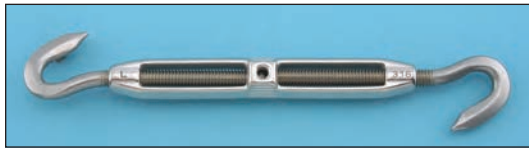

ITEM	A (size)	B (adjustment)	C	D	WLL (lb)	WT (lb)
S0154-HH05	3/16"	2.50"	4.94"	0.30"	100	0.07
S0154-HH07	1/4"	3.00"	6.18"	0.38"	200	0.17
S0154-HH08	5/16"	4.00"	7.56"	0.45"	400	0.32
S0154-HH10	3/8"	6.00"	10.38"	0.52"	700	0.66
S0154-HH13	1/2"	6.00"	10.62"	0.56"	1,000	1.26
S0154-HH16	5/8"	8.00"	14.38"	0.75"	1,500	2.30
S0154-HH20	3/4"	10.00"	16.87"	0.97"	2,000	3.85

**NOTE:**  
ECONOMICAL, YET HIGH QUALITY TURNBUCKLE WITH PRECISION CAST BODY. HOOKS ARE FORMED. THREADS ARE STANDARD "UNC". BODIES ONLY ON PAGE 24. NUTS ARE AVAILABLE (PAGE 100), BUT SOLD SEPARATELY.

## TURNBUCKLE STUB & STUB 316 STAINLESS STEEL

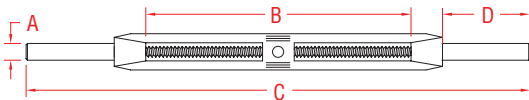

ITEM	A (size)	B (adjustment)	C	D	WT (lb)
S0154-SS05	3/16"	2.50"	5.04"	0.85"	0.08
S0154-SS07	1/4"	3.00"	9.04"	2.50"	0.20
S0154-SS08	5/16"	4.00"	10.56"	2.75"	0.36
S0154-SS10	3/8"	6.00"	13.04"	2.85"	0.70
S0154-SS13	1/2"	6.00"	14.42"	3.35"	1.32
S0154-SS16	5/8"	8.00"	16.28"	3.25"	2.26
S0154-SS20	3/4"	10.00"	18.75"	3.38"	3.66

**NOTE:**  
ECONOMICAL, YET HIGH QUALITY TURNBUCKLE WITH PRECISION CAST BODY. THREADS ARE STANDARD "UNC". BODIES ONLY ON PAGE 24. NUTS ARE AVAILABLE (PAGE 100), BUT SOLD SEPARATELY.

## TURNBUCKLE JAW & JAW 316 STAINLESS STEEL

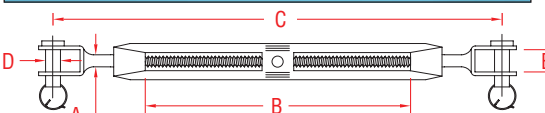

ITEM	A (size)	B (adjustment)	C	D	E	WLL (lb)	WT (lb)
S0154-JJ05	3/16"	2.50"	4.81"	0.18"	0.30"	300	0.10
S0154-JJ07	1/4"	3.00"	5.75"	0.22"	0.38"	440	0.22
S0154-JJ08	5/16"	4.00"	7.12"	0.30"	0.40"	800	0.36
S0154-JJ10	3/8"	6.00"	10.00"	0.37"	0.46"	1,200	0.78
S0154-JJ13	1/2"	6.00"	11.00"	0.46"	0.59"	2,200	1.36
S0154-JJ16	5/8"	8.00"	14.50"	0.63"	0.69"	2,800	2.82
S0154-JJ20	3/4"	10.00"	18.00"	0.73"	0.76"	3,500	4.80

**NOTE:**  
ECONOMICAL, YET HIGH QUALITY TURNBUCKLE WITH PRECISION CAST BODY. JAWS ARE FORMED AND WELDED. THREADS ARE STANDARD "UNC". BODIES ONLY ON PAGE 24. NUTS ARE AVAILABLE (PAGE 100), BUT SOLD SEPARATELY.

**LIMITED LIFETIME WARRANTY**

**SUNCOR STAINLESS®**

TEL 508-732-9191 • FAX 508-732-9798 • ORDERS ONLY 800-394-2222

www.suncorstainless.com

# TURNBUCKLES

## TURNBUCKLE JAW & JAW 316 STAINLESS STEEL

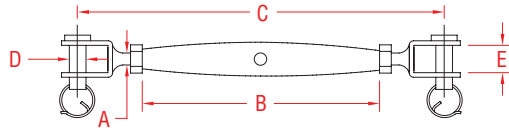

ITEM	A	B	C	D	E	WLL	WT
	(size)					(lb)	(lb)
S0101-0005	3/16"	3.13"	4.75"	0.18"	0.30"	300	0.11
S0101-0007	1/4"	3.50"	5.50"	0.22"	0.38"	440	0.19
S0101-0008	5/16"	4.31"	7.06"	0.30"	0.40"	800	0.36
S0101-0010	3/8"	4.87"	7.75"	0.37"	0.46"	1,200	0.59
S0101-0013	1/2"	6.10"	9.50"	0.46"	0.59"	2,200	1.02
S0101-0016	5/8"	7.50"	13.00"	0.62"	0.85"	2,800	2.44

**NOTE:**  
THIS CLOSED TYPE TURNBUCKLE IS IDEAL FOR ARCHITETURAL APPLICATIONS. BODY IS MACHINED FROM TUBING. JAWS ARE FORMED AND WELDED. BODIES ONLY ON PAGE 24. THREADS ARE STANDARD "UNC".

## TURNBUCKLE JAW & SWAGE 316 STAINLESS STEEL

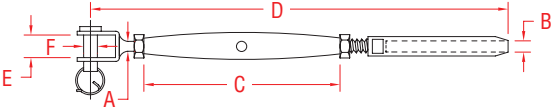

ITEM	A	B	C	D	E	F	WT
	(size)						(lb)
S0781-0703	1/4"	1/8"	4.20"	7.50"	0.38"	0.22"	0.19
S0781-0704	1/4"	5/32"	4.20"	7.75"	0.38"	0.22"	0.21
S0781-0705	1/4"	3/16"	4.25"	8.25"	0.38"	0.22"	0.23
S0781-0904	5/16"	5/32"	4.32"	8.19"	0.40"	0.30"	0.35
S0781-0905	5/16"	3/16"	4.32"	8.56"	0.40"	0.30"	0.37
S0781-1005	3/8"	3/16"	4.90"	9.25"	0.46"	0.37"	0.53
S0781-1007	3/8"	1/4"	4.90"	10.00"	0.46"	0.37"	0.60
S0781-1307	1/2"	1/4"	5.87"	11.87"	0.59"	0.46"	1.09
S0781-1309	1/2"	5/16"	5.87"	12.62"	0.59"	0.46"	1.21
S0781-1610	5/8"	3/8"	7.48"	15.00"	0.70"	0.55"	2.50
S0781-2013	3/4"	1/2"	8.66"	17.40"	0.94"	0.75"	4.20

**NOTE:**  
OTHER CONFIGURATIONS ARE AVAILABLE. BODIES ONLY ON PAGE 24. THREADS ARE "UNF". MACHINE SWAGE ONLY.

## TURNBUCKLE TOGGLE & SWAGE 316 STAINLESS STEEL

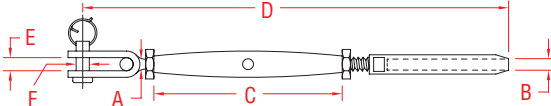

ITEM	A	B	C	D	E	F	WT
	(size)						(lb)
S0782-0501	3/16"	1/16"	3.56"	6.62"	0.26"	0.19"	0.14
S0782-0502	3/16"	3/32"	3.56"	6.87"	0.26"	0.19"	0.14
S0782-0702	1/4"	3/32"	4.20"	7.62"	0.35"	0.23"	0.22
S0782-0703	1/4"	1/8"	4.20"	7.87"	0.35"	0.23"	0.25
S0782-0704	1/4"	5/32"	4.20"	8.12"	0.35"	0.23"	0.27
S0782-0705	1/4"	3/16"	4.20"	8.64"	0.35"	0.23"	0.29
S0782-0904	5/16"	5/32"	4.32"	8.56"	0.40"	0.31"	0.40
S0782-0905	5/16"	3/16"	4.32"	9.00"	0.40"	0.31"	0.43
S0782-1005	3/8"	3/16"	4.90"	9.75"	0.56"	0.37"	0.64
S0782-1007	3/8"	1/4"	4.90"	10.44"	0.56"	0.37"	0.69
S0782-1307	1/2"	1/4"	5.87"	12.25"	0.63"	0.47"	1.32
S0782-1309	1/2"	5/16"	5.87"	13.00"	0.63"	0.47"	1.50
S0782-1610	5/8"	3/8"	7.50"	17.00"	0.80"	0.62"	2.69

**NOTE:** OTHER CONFIGURATIONS ARE AVAILABLE. BODIES ONLY ON PAGE 24. THREADS ARE "UNF". MACHINE SWAGE ONLY.

## TURNBUCKLE TOGGLE & TOGGLE 316 STAINLESS STEEL

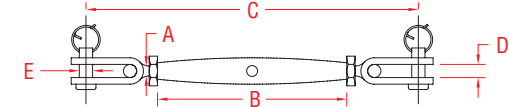

ITEM	A	B	C	D	E	WLL	WT
	(size)					(lb)	(lb)
S0783-0005	3/16"	3.56"	6.00"	0.26"	0.19"	240	0.17
S0783-0007	1/4"	4.20"	6.87"	0.35"	0.23"	550	0.26
S0783-0008	5/16"	4.32"	7.63"	0.40"	0.31"	860	0.50
S0783-0010	3/8"	4.90"	9.12"	0.56"	0.37"	1,700	0.72
S0783-0013	1/2"	5.87"	10.87"	0.63"	0.47"	2,060	1.34
S0783-0016	5/8"	7.50"	13.75"	0.80"	0.62"	2,800	3.50

**NOTE:**  
THIS TURNBUCKLE IS IDEAL FOR ARCHITECTURAL AND MARINE APPLICATIONS. BODY IS MACHINED FROM TUBING. BODIES ONLY ON PAGE 24. TOGGLES ARE FORMED. THREADS ARE "UNF".



ORDERS ONLY: 800-394-2222  
(USA+CANADA)

Key:

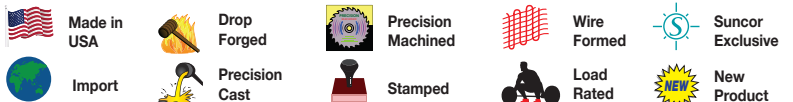

All logos, icons, images, measurements and descriptions are the sole property of Suncor Stainless, Inc.  
© 2020 Suncor Stainless, Inc.

## TURNBUCKLE WALL MOUNT & SWAGE 316 STAINLESS STEEL

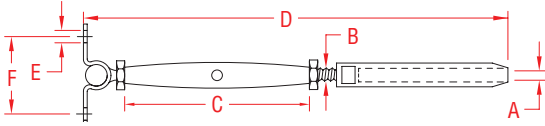

ITEM	A	B	C	D	E	F	WT
	(size)						(lb)
S0784-0703	1/8"	1/4"	4.20"	7.25"	0.25"	1.58"	0.25
S0784-0704	5/32"	1/4"	4.20"	7.50"	0.25"	1.58"	0.28
S0784-0705	3/16"	1/4"	4.20"	8.00"	0.25"	1.58"	0.32

**NOTE:**  
THREADS ARE "UNF". MACHINE SWAGE ONLY. TURNBUCKLES WITH QUICK ATTACH™ FITTINGS ARE SHOWN ON PAGES 47.

**BODIES ONLY ON PAGE 24.**

**REFERENCE "FASTENER MATCHING CHART" (PAGE 164) FOR COMPATIBLE FASTENERS.**

## TURNBUCKLE TOGGLE & SWAGE CHROMED BRONZE BODY & STAINLESS ENDS

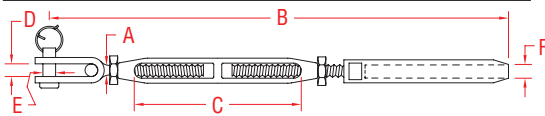

ITEM	A	B	C	D	E	F	WT
	(size)		(adjustment)		(wire)		(lb)
S0786-0703	1/4"	8.37"	3.50"	0.35"	0.23"	1/8"	0.27
S0786-0704	1/4"	8.81"	3.50"	0.35"	0.23"	5/32"	0.28
S0786-0705	1/4"	8.87"	3.50"	0.35"	0.23"	3/16"	0.32
S0786-0904	5/16"	9.25"	3.80"	0.40"	0.31"	5/32"	0.42
S0786-0905	5/16"	9.62"	3.80"	0.40"	0.31"	3/16"	0.44
S0786-1005	3/8"	11.50"	4.40"	0.56"	0.37"	3/16"	0.77
S0786-1006	3/8"	11.50"	4.40"	0.56"	0.37"	7/32"	0.79
S0786-1007	3/8"	11.50"	4.40"	0.56"	0.37"	1/4"	0.81
S0786-1307	1/2"	13.00"	4.62"	0.63"	0.47"	1/4"	1.48
S0786-1308	1/2"	13.25"	4.62"	0.63"	0.47"	9/32"	1.50
S0786-1309	1/2"	13.75"	4.62"	0.63"	0.47"	5/16"	1.50

**NOTE: THREADS ARE "UNF". MACHINE SWAGE ONLY.**

## TURNBUCKLE TOGGLE & SWAGE BRONZE BODY & STAINLESS ENDS

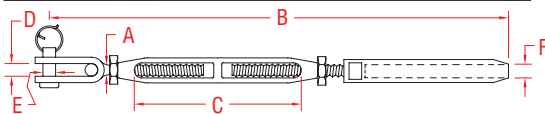

ITEM	A	B	C	D	E	F	WT
	(size)		(adjustment)		(wire)		(lb)
S0789-0703	1/4"	8.37"	3.50"	0.35"	0.23"	1/8"	0.27
S0789-0704	1/4"	8.81"	3.50"	0.35"	0.23"	5/32"	0.28
S0789-0705	1/4"	8.87"	3.50"	0.35"	0.23"	3/16"	0.32
S0789-0904	5/16"	9.25"	3.80"	0.40"	0.31"	5/32"	0.42
S0789-0905	5/16"	9.62"	3.80"	0.40"	0.31"	3/16"	0.44
S0789-1005	3/8"	11.50"	4.40"	0.56"	0.37"	3/16"	0.63
S0789-1007	3/8"	11.50"	4.40"	0.56"	0.37"	1/4"	0.67
S0789-1307	1/2"	13.00"	4.62"	0.63"	0.47"	1/4"	1.48
S0789-1308	1/2"	13.25"	4.62"	0.63"	0.47"	9/32"	1.50
S0789-1309	1/2"	13.75"	4.62"	0.63"	0.47"	5/16"	1.50

**NOTE: THREADS ARE "UNF". OTHER CONFIGURATIONS, SUCH AS TOGGLE/TOGGLE ARE AVAILABLE.**

## TURNBUCKLE TOGGLE & TOGGLE CHROMED BRONZE BODY & STAINLESS ENDS

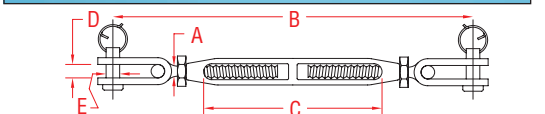

ITEM	A	B	C	D	E	WLL	WT
	(size)		(adjustment)		(lb)		(lb)
S0785-0007	1/4"	7.12"	3.50"	0.35"	0.23"	550	0.28
S0785-0009	5/16"	8.25"	3.80"	0.40"	0.31"	860	0.50
S0785-0010	3/8"	9.75"	4.40"	0.56"	0.37"	1,700	1.00
S0785-0013	1/2"	11.62"	4.62"	0.63"	0.47"	2,060	1.72

**NOTE:**  
SILICON BRONZE, THEN CHROMED TO PREVENT GALLING. THE END FITTINGS ARE MADE FROM 316 STAINLESS STEEL. THREADS ARE "UNF".

## TURNBUCKLE JAW & JAW CHROMED BRONZE BODY & ENDS

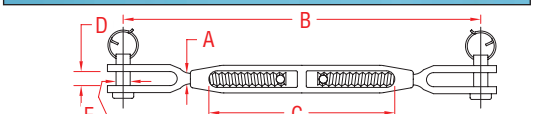

ITEM	A	B	C	D	E	WLL	WT
	(size)		(adjustment)		(lb)		(lb)
S0787-0007	1/4"	7.25"	3.50"	0.25"	0.25"	550	0.30
S0787-0009	5/16"	8.50"	3.80"	0.31"	0.31"	860	0.45
S0787-0010	3/8"	8.87"	4.40"	0.38"	0.38"	1,700	0.86

**NOTE:**  
COMPLETE TURNBUCKLE IS FORGED SILICON BRONZE, THEN CHROMED TO PREVENT GALLING. THREADS ARE "UNF". NUTS ARE AVAILABLE (PAGE 100), BUT SOLD SEPARATELY.

**LIMITED LIFETIME WARRANTY**

**SUNCOR STAINLESS®**

TEL 508-732-9191 • FAX 508-732-9798 • ORDERS ONLY 800-394-2222

www.suncorstainless.com

# TURNBUCKLES

## LIFELINE ADJUSTER 316 STAINLESS STEEL

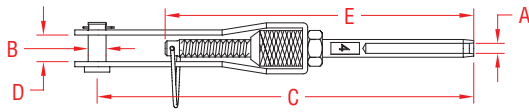
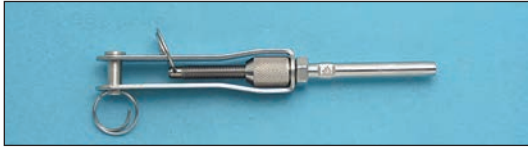

ITEM	A	B	C	D	E	WT
	(size)					(lb)
S0745-0003	1/8"	0.24"	5.25"	0.42"	4.35"	0.16
S0745-0004	5/32"	0.24"	5.67"	0.42"	4.70"	0.18
S0745-0005	3/16"	0.24"	5.89"	0.42"	4.97"	0.20

**NOTE:**  
TENSIONER DESIGNED FOR, BUT NOT LIMITED TO, LIFELINE APPLICATIONS. S0731-0703 SWAGE STUD (PAGE 34) IS USED IN THIS ASSEMBLY.

## HAND SWAGE TENSIONER W/STUD 316L STAINLESS STEEL

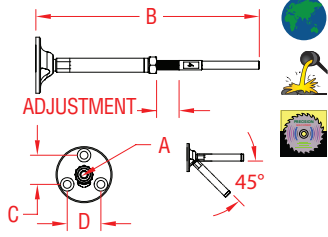

ITEM	A	B	C	D	ADJUSTMENT	WT
	(cable)					(lb)
S0748-H003	1/8"	6.12"	0.78"	0.90"	1.35"	0.14

**NOTE:**  
DESIGNED FOR HAND SWAGE USE ONLY. THE HANDISWAGE™ TENSIONER IS USED IN ARCHITECTURAL CABLE RAILING APPLICATIONS. THIS TENSIONER IS MADE FROM GRADE 316L STAINLESS STEEL FOR CORROSION RESISTANCE AND DURABILITY. IT FEATURES A SLOTTED BASE TO ACHIEVE ANGLES UP TO 45 DEGREES. CRIMP THE STUD ONTO CABLE USING THE HAND SWAGER (E0113-H600).

## TURNBUCKLE EYE & EYE ALUMINUM & STAINLESS STEEL

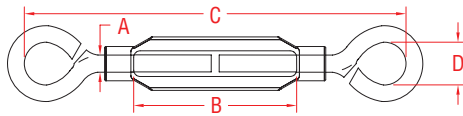
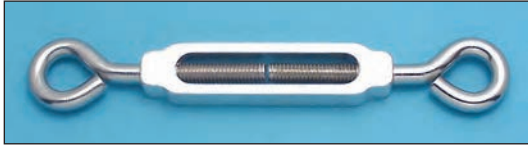

ITEM	A	B	C	D	WLL	WT
	(size)	(adjustment)			(lb)	(lb)
A0154-EE05-A	3/16"	1.61"	3.72"	0.31"	70	0.04
A0154-EE07-A	1/4"	2.04"	4.98"	0.52"	160	0.12
A0154-EE08-A	5/16"	2.62"	5.88"	0.49"	230	0.20
A0154-EE10-A	3/8"	2.98"	7.40"	0.63"	300	0.38

**NOTE:**  
LOWEST COST TURNBUCKLE. BODY IS ALUMINUM; ENDS ARE 304 STAINLESS STEEL. TO BE USED IN LIGHT DUTY APPLICATIONS ONLY. NUTS ARE AVAILABLE (PAGE 100), BUT SOLD SEPARATELY.

## TURNBUCKLE HOOK & EYE ALUMINUM & STAINLESS STEEL

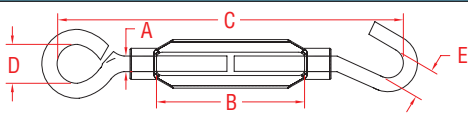

ITEM	A	B	C	D	E	WLL	WT
	(size)	(adjustment)				(lb)	(lb)
A0154-HE05-A	3/16"	1.61"	3.70"	0.31"	0.26"	40	0.04
A0154-HE07-A	1/4"	2.04"	5.02"	0.52"	0.48"	80	0.10
A0154-HE08-A	5/16"	2.62"	6.05"	0.49"	0.48"	125	0.22
A0154-HE10-A	3/8"	2.98"	7.37"	0.63"	0.60"	180	0.34

**NOTE:**  
LOWEST COST TURNBUCKLE. BODY IS ALUMINUM; ENDS ARE 304 STAINLESS STEEL. TO BE USED IN LIGHT DUTY APPLICATIONS ONLY. NUTS ARE AVAILABLE (PAGE 100), BUT SOLD SEPARATELY.

## TURNBUCKLE HOOK & HOOK ALUMINUM & STAINLESS STEEL

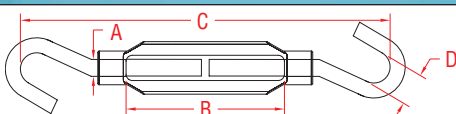
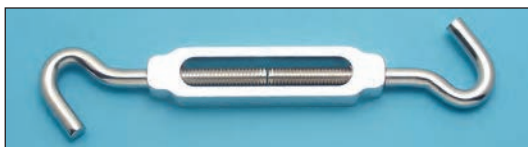

ITEM	A	B	C	D	WLL	WT
	(size)	(adjustment)			(lb)	(lb)
A0154-HH05-A	3/16"	1.61"	3.90"	0.26"	70	0.04
A0154-HH07-A	1/4"	2.04"	5.08"	0.48"	100	0.11
A0154-HH08-A	5/16"	2.62"	6.22"	0.48"	150	0.20
A0154-HH10-A	3/8"	2.98"	7.33"	0.60"	200	0.36

**NOTE:**  
LOWEST COST TURNBUCKLE. BODY IS ALUMINUM; ENDS ARE 304 STAINLESS STEEL. TO BE USED IN LIGHT DUTY APPLICATIONS ONLY. NUTS ARE AVAILABLE (PAGE 100), BUT SOLD SEPARATELY.



Key:

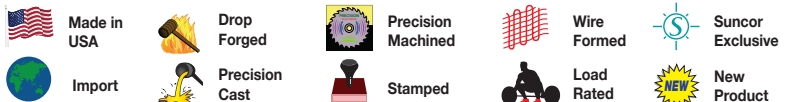

ORDERS ONLY: 800-394-2222  
(USA+CANADA)

All logos, icons, images, measurements and descriptions are the sole property of Suncor Stainless, Inc.  
© 2020 Suncor Stainless, Inc.

## RIGGING TOGGLE

316 STAINLESS STEEL

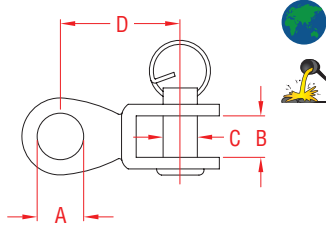

ITEM	A	B	C	D	WLL	WT
	(size)				(lb)	(lb)
S0168-0005	7/32"	0.24"	0.20"	0.87"	300	0.05
S0168-0006	1/4"	0.28"	0.24"	1.12"	400	0.06
S0168-0008	11/32"	0.40"	0.32"	1.25"	800	0.10
S0168-0010	3/8"	0.48"	0.36"	1.43"	1,200	0.16
S0168-0012	1/2"	0.52"	0.48"	2.00"	1,600	0.32

**NOTE:**  
INCLUDES REMOVABLE CLEVIS PIN.

## RIGGING TOGGLE

316 STAINLESS STEEL

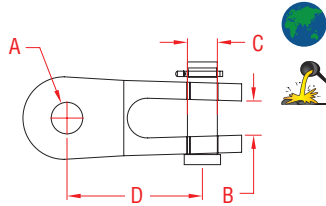

ITEM	A	B	C	D	WLL	WT
	(size)				(lb)	(lb)
S0168-SS07	1/4"	0.26"	0.25"	1.01"	440	0.08
S0168-SS08	5/16"	0.34"	0.31"	1.25"	800	0.11
S0168-SS10	3/8"	0.40"	0.37"	1.50"	1,200	0.17
S0168-SS12	7/16"	0.48"	0.43"	1.94"	1,600	0.28
S0168-SS13	1/2"	0.56"	0.50"	1.87"	2,200	0.45
S0168-SS16	5/8"	0.63"	0.63"	2.60"	3,500	0.84

**NOTE:**  
INCLUDES REMOVABLE CLEVIS PIN.

## UNIVERSAL LINK

316 STAINLESS STEEL

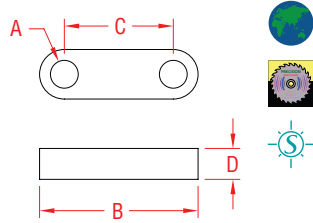

ITEM	SIZE	A	B	C	D	WT
						(lb)
S0100-0007	1/4"	0.28"	1.61"	1.11"	0.31"	0.05
S0100-0008	5/16"	0.31"	1.87"	1.22"	0.34"	0.08
S0100-0010	3/8"	0.40"	2.12"	1.38"	0.46"	0.14
S0100-0013	1/2"	0.50"	2.71"	1.71"	0.50"	0.27

**NOTE:**  
DESIGNED FOR LINKING COMPONENTS WITH MATCHING PIN DIAMETERS. EASILY CONNECT JAWS, SHACKLES, TOGGLES, YOKE ENDS, ETC. THIS UNIVERSAL LINK IS A SIMPLE, YET VERSATILE RIGGING SOLUTION.



## YOKE END UNTHREADED

316-NM STAINLESS STEEL

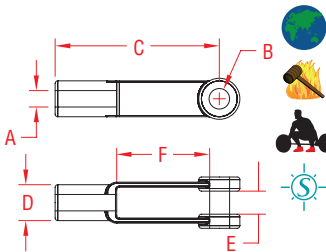

ITEM	SIZE	A	B	C	D	E	F	WLL	WT
								(lb)	(lb)
S0113-U005	3/16"	0.15"	0.19"	1.56"	0.31"	0.19"	0.89"	300	0.04
S0113-U007	1/4"	0.21"	0.25"	2.00"	0.44"	0.29"	1.08"	500	0.08
S0113-U008	5/16"	0.27"	0.31"	2.25"	0.50"	0.33"	1.26"	800	0.16
S0113-U010	3/8"	0.33"	0.38"	2.55"	0.63"	0.42"	1.45"	1,200	0.24
S0113-U013	1/2"	0.45"	0.50"	3.00"	0.81"	0.58"	1.65"	2,200	0.50
S0113-U016	5/8"	0.57"	0.63"	4.94"	1.06"	0.70"	3.37"	3,500	1.14
S0113-U020	3/4"	0.68"	0.75"	6.06"	1.25"	0.79"	4.25"	5,200	2.06

**NOTE:**  
SOLD WITH CLEVIS PINS.  
THIS ITEM IS NOT THREADED. CALL FOR SPECIAL THREADS.

## YOKE END THREADED

316-NM STAINLESS STEEL  
UNC

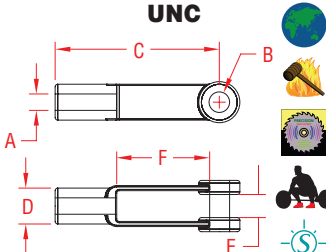

ITEM	A	B	C	D	E	F	WLL	WT
	(thread size)						(lb)	(lb)
S0113-RC05	3/16"	0.19"	1.56"	0.31"	0.19"	0.89"	300	0.04
S0113-RC07	1/4"	0.25"	2.00"	0.44"	0.29"	1.08"	500	0.10
S0113-RC08	5/16"	0.31"	2.25"	0.50"	0.33"	1.26"	800	0.14
S0113-RC10	3/8"	0.38"	2.55"	0.63"	0.42"	1.45"	1,200	0.24
S0113-RC13	1/2"	0.50"	3.00"	0.81"	0.58"	1.65"	2,200	0.50
S0113-RC16	5/8"	0.63"	4.94"	1.06"	0.70"	3.37"	3,500	1.14
S0113-RC20	3/4"	0.75"	6.06"	1.25"	0.79"	4.25"	5,200	2.06

**NOTE:**  
SOLD WITH CLEVIS PINS.  
"UNC" RIGHT HAND THREADED.

LIMITED LIFETIME  
WARRANTY

**SUNCOR STAINLESS®**

TEL 508-732-9191 • FAX 508-732-9798 • ORDERS ONLY 800-394-2222

www.suncorstainless.com



# TURNBUCKLE COMPONENTS

TURNBUCKLE COMPONENTS

## TURNBUCKLE BODY - CLOSED 316 STAINLESS STEEL

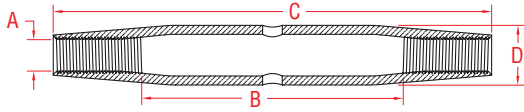
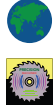
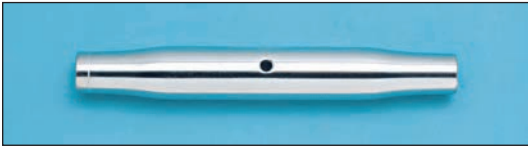

ITEM	A (size)	B (adjustment)	C	D	WLL (lb)	WT (lb)
<b>UNC THREAD</b>						
P0101-BD05	3/16"	3.00"	3.65"	0.39"	300	0.06
P0101-BD07	1/4"	3.50"	4.22"	0.39"	440	0.07
P0101-BD08	5/16"	3.50"	4.42"	0.54"	800	0.14
P0101-BD10	3/8"	3.50"	4.75"	0.67"	1,200	0.19
P0101-BD13	1/2"	4.75"	6.10"	0.79"	2,200	0.28
P0101-BD16	5/8"	5.50"	7.53"	1.08"	2,800	0.68
<b>UNF THREAD</b>						
P0780-BD05	3/16"	3.00"	3.65"	0.39"	300	0.06
P0780-BD07	1/4"	3.50"	4.22"	0.39"	440	0.07
P0780-BD09	5/16"	3.50"	4.42"	0.54"	800	0.14
P0780-BD10	3/8"	3.50"	4.75"	0.67"	1,200	0.19
P0780-BD13	1/2"	4.75"	6.10"	0.79"	2,200	0.28
P0780-BD16	5/8"	5.50"	7.53"	1.08"	2,800	0.68
P0780-BD20	3/4"	7.00"	8.70"	1.32"	3,500	1.02
P0780-BD22	7/8"	12.00"	15.00"	1.47"	5,200	3.25

**NOTE:**  
MULTIPLE CONFIGURATIONS AVAILABLE FOR USE WITH THIS BODY.

## TURNBUCKLE BODY 316-NM STAINLESS STEEL

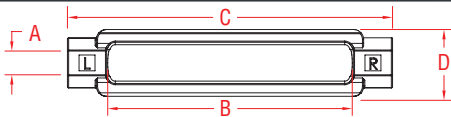
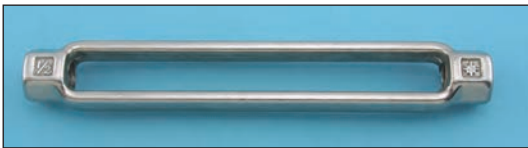

ITEM	A (size)	B (adjustment)	C	D	WLL (lb)	WT (lb)
S0106-BD07	1/4"	4.00"	4.75"	0.72"	500	0.15
S0106-BD08	5/16"	4.50"	5.50"	0.82"	800	0.25
S0106-BD10	3/8"	6.00"	7.13"	0.97"	1,200	0.35
S0106-BD13	1/2"	6.00"	7.50"	1.16"	2,200	0.55
S0106-BD16	5/8"	6.00"	7.81"	1.38"	3,500	0.90
S0106-BD20	3/4"	6.00"	8.19"	1.69"	5,200	1.15
S0106-BD25	1"	6.00"	9.00"	2.31"	8,000	2.69
S0106-BD25-1	1"	12.00"	14.81"	2.31"	8,000	4.17
S0106-BD32-1	1-1/4"	12.00"	15.13"	2.62"	12,500	5.90
S0106-BD38-1	1-1/2"	12.00"	15.81"	3.20"	17,000	9.57

**NOTE:**  
MEETS WLL & DIMENSIONS OF ASTM SPECIFICATION F1145-92, TYPE 1.

## TURNBUCKLE BODY - OPEN UNC THREAD - 316 STAINLESS STEEL

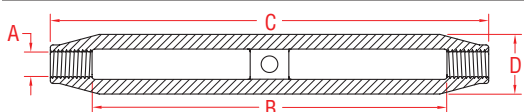
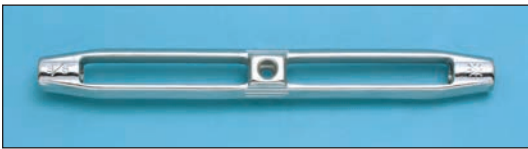

ITEM	A (size)	B (adjustment)	C	D	WLL (lb)	WT (lb)
P0105-BD05	3/16"	2.50"	3.28"	0.44"	300	0.04
P0105-BD07	1/4"	3.00"	3.98"	0.61"	440	0.10
P0105-BD08	5/16"	4.00"	5.10"	0.70"	800	0.15
P0105-BD10	3/8"	6.00"	7.50"	0.85"	1,200	0.34
P0105-BD13	1/2"	6.00"	7.41"	1.12"	2,200	0.61
P0105-BD16	5/8"	8.00"	9.94"	1.34"	2,800	1.08
P0105-BD20	3/4"	10.00"	12.10"	1.70"	3,500	1.90

**NOTE:**  
MULTIPLE CONFIGURATIONS AVAILABLE FOR USE WITH THIS BODY.

## TURNBUCKLE TOGGLE UNF THREAD 316 STAINLESS STEEL

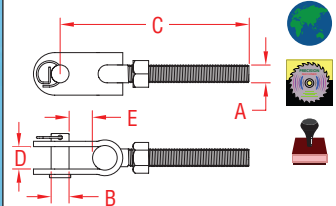

ITEM	A (size)	B	C	D	E	WLL (lb)	WT (lb)
<b>RIGHT HAND, UNF</b>							
P0780-RT05	3/16"	0.19"	3.00"	0.25"	0.58"	240	0.05
P0780-RT07	1/4"	0.23"	3.41"	0.37"	0.45"	550	0.09
P0780-RT09	5/16"	0.31"	3.95"	0.39"	0.61"	860	0.17
P0780-RT10	3/8"	0.37"	4.35"	0.52"	0.75"	1,700	0.27
P0780-RT13	1/2"	0.47"	5.60"	0.59"	0.62"	2,060	0.66
P0780-RT16	5/8"	0.62"	6.65"	0.79"	0.83"	2,800	1.45
<b>LEFT HAND, UNF</b>							
P0780-LT05	3/16"	0.19"	3.00"	0.25"	0.58"	240	0.05
P0780-LT07	1/4"	0.23"	3.41"	0.37"	0.45"	550	0.09
P0780-LT09	5/16"	0.31"	3.95"	0.39"	0.61"	860	0.17
P0780-LT10	3/8"	0.37"	4.35"	0.52"	0.75"	1,700	0.27
P0780-LT13	1/2"	0.47"	5.60"	0.59"	0.62"	2,060	0.66
P0780-LT16	5/8"	0.62"	6.65"	0.79"	0.83"	2,800	1.45

**NOTE:**  
USE WITH "CLOSED" TURNBUCKLE BODY (P0780-BD, ABOVE).

**Key:**

## TURNBUCKLE EYE - FORGED UNC THREAD - 316 STAINLESS STEEL

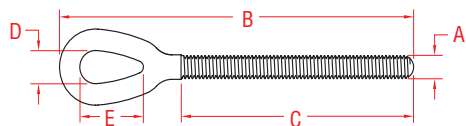

ITEM	A	B	C	D	E	WLL	WT
	(size)					(lb)	(lb)
<b>RIGHT HAND, UNC</b>							
P0106-RE07	1/4"	4.15"	2.65"	0.34"	0.80"	500	0.07
P0106-RE08	5/16"	4.95"	2.98"	0.44"	0.96"	800	0.13
P0106-RE10	3/8"	6.12"	4.02"	0.54"	1.10"	1,200	0.23
P0106-RE13	1/2"	7.00"	4.16"	0.72"	1.40"	2,200	0.43
P0106-RE16	5/8"	8.00"	4.40"	0.89"	1.74"	3,500	0.75
P0106-RE20	3/4"	8.75"	4.75"	1.00"	2.04"	5,200	1.30
P0106-RE25	1"	10.97"	5.06"	1.34"	3.00"	8,000	3.17
P0106-RE25-1	1"	14.00"	8.05"	1.34"	3.00"	8,000	3.71
P0106-RE32-1	1-1/4"	14.91"	7.95"	1.58"	3.37"	12,500	5.94
<b>LEFT HAND, UNC</b>							
P0106-LE07	1/4"	4.15"	2.65"	0.34"	0.80"	500	0.07
P0106-LE08	5/16"	4.95"	2.98"	0.44"	0.96"	800	0.13
P0106-LE10	3/8"	6.12"	4.02"	0.54"	1.10"	1,200	0.23
P0106-LE13	1/2"	7.00"	4.16"	0.72"	1.40"	2,200	0.43
P0106-LE16	5/8"	8.00"	4.40"	0.89"	1.74"	3,500	0.75
P0106-LE20	3/4"	8.75"	4.75"	1.00"	2.04"	5,200	1.30
P0106-LE25	1"	10.97"	5.06"	1.34"	3.00"	8,000	3.17
P0106-LE25-1	1"	14.00"	8.05"	1.34"	3.00"	8,000	3.71
P0106-LE32-1	1-1/4"	14.91"	7.95"	1.58"	3.37"	12,500	5.94

**NOTE:**  
USE WITH FORGED "OPEN" TURNBUCKLE BODY (S0106-BD, PAGE 24).

## TURNBUCKLE JAW - FORGED UNC THREAD 316 STAINLESS STEEL

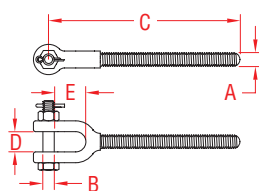

ITEM	A	B	C	D	E	WLL	WT
	(size)					(lb)	(lb)
<b>RIGHT HAND, UNC</b>							
P0106-RJ07	1/4"	0.25"	3.88"	0.44"	0.66"	500	0.11
P0106-RJ08	5/16"	0.25"	4.60"	0.50"	0.85"	800	0.20
P0106-RJ10	3/8"	0.31"	5.31"	0.56"	0.88"	1,200	0.30
P0106-RJ13	1/2"	0.38"	6.04"	0.63"	1.07"	2,200	0.58
P0106-RJ16	5/8"	0.50"	6.87"	0.75"	1.42"	3,500	1.04
P0106-RJ20	3/4"	0.63"	7.56"	1.00"	1.50"	5,200	1.84
P0106-RJ25	1"	0.88"	9.09"	1.25"	2.17"	8,000	4.14
P0106-RJ25-1	1"	0.88"	12.14"	1.25"	2.17"	8,000	4.73
P0106-RJ32-1	1-1/4"	1.11"	13.49"	1.88"	2.90"	12,500	8.41
<b>LEFT HAND, UNC</b>							
P0106-LJ07	1/4"	0.25"	3.88"	0.44"	0.66"	500	0.11
P0106-LJ08	5/16"	0.25"	4.60"	0.50"	0.85"	800	0.20
P0106-LJ10	3/8"	0.31"	5.31"	0.56"	0.88"	1,200	0.30
P0106-LJ13	1/2"	0.38"	6.04"	0.63"	1.07"	2,200	0.58
P0106-LJ16	5/8"	0.50"	6.87"	0.75"	1.42"	3,500	1.04
P0106-LJ20	3/4"	0.63"	7.56"	1.00"	1.50"	5,200	1.84
P0106-LJ25	1"	0.88"	9.09"	1.25"	2.17"	8,000	4.14
P0106-LJ25-1	1"	0.88"	12.14"	1.25"	2.17"	8,000	4.73
P0106-LJ32-1	1-1/4"	1.11"	13.49"	1.88"	2.90"	12,500	8.41

**NOTE:**  
USE WITH FORGED "OPEN" TURNBUCKLE BODY (S0106-BD, PAGE 24).

## TURNBUCKLE STUB - FORGED UNC THREAD - 316 STAINLESS STEEL

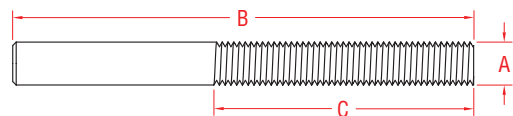

ITEM	A	B	C	WLL	WT
	(size)			(lb)	(lb)
<b>RIGHT HAND, UNC</b>					
P0106-RS05	3/16"	2.50"	1.80"	300	0.02
P0106-RS07	1/4"	4.50"	2.50"	500	0.05
P0106-RS08	5/16"	5.25"	3.00"	800	0.10
P0106-RS10	3/8"	6.50"	4.00"	1,200	0.18
P0106-RS13	1/2"	7.00"	4.00"	2,200	0.31
P0106-RS16	5/8"	7.50"	4.32"	3,500	0.58
P0106-RS20	3/4"	8.00"	5.00"	5,200	0.92
P0106-RS25	1"	9.00"	5.00"	8,000	1.84
P0106-RS25-1	1"	12.00"	8.18"	8,000	2.40
<b>LEFT HAND, UNC</b>					
P0106-LS05	3/16"	2.50"	1.80"	300	0.02
P0106-LS07	1/4"	4.50"	2.50"	500	0.05
P0106-LS08	5/16"	5.25"	3.00"	800	0.10
P0106-LS10	3/8"	6.50"	4.00"	1,200	0.18
P0106-LS13	1/2"	7.00"	4.00"	2,200	0.31
P0106-LS16	5/8"	7.50"	4.32"	3,500	0.58
P0106-LS20	3/4"	8.00"	5.00"	5,200	0.92
P0106-LS25	1"	9.00"	5.00"	8,000	1.84
P0106-LS25-1	1"	12.00"	8.18"	8,000	2.40

**NOTE:**  
USE WITH FORGED "OPEN" TURNBUCKLE BODY (S0106-BD, PAGE 24).

**LIMITED LIFETIME  
WARRANTY**

**SUNCOR STAINLESS®**

TEL 508-732-9191 • FAX 508-732-9798 • ORDERS ONLY 800-394-2222

www.suncorstainless.com

# TURNBUCKLE COMPONENTS

TURNBUCKLE COMPONENTS

## TURNBUCKLE STUD - THREADED UNC THREAD - 316 STAINLESS STEEL

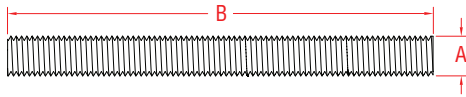
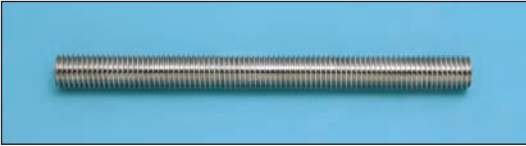

ITEM	A	B	WLL	WT
	(size)		(lb)	(lb)
<b>RIGHT HAND, UNC</b>				
P0106-RT05	3/16"	2.50"	300	0.02
P0106-RT07	1/4"	4.50"	500	0.05
P0106-RT08	5/16"	5.25"	800	0.09
P0106-RT10	3/8"	6.50"	1,200	0.16
P0106-RT13	1/2"	7.00"	2,200	0.31
P0106-RT16	5/8"	7.50"	3,500	0.53
P0106-RT20	3/4"	8.00"	5,200	0.83
P0106-RT25	1"	9.00"	8,000	1.69
<b>LEFT HAND, UNC</b>				
P0106-LT05	3/16"	2.50"	300	0.02
P0106-LT07	1/4"	4.50"	500	0.05
P0106-LT08	5/16"	5.25"	800	0.09
P0106-LT10	3/8"	6.50"	1,200	0.16
P0106-LT13	1/2"	7.00"	2,200	0.31
P0106-LT16	5/8"	7.50"	3,500	0.53
P0106-LT20	3/4"	8.00"	5,200	0.83
P0106-LT25	1"	9.00"	8,000	1.69

**NOTE:**  
USE WITH FORGED "OPEN" TURNBUCKLE BODY (S0106-BD, PAGE 24).

## TURNBUCKLE EYE UNC THREAD - 316 STAINLESS STEEL

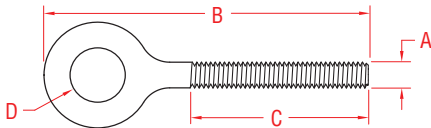

ITEM	A	B	C	D	WLL	WT
	(size)				(lb)	(lb)
<b>RIGHT HAND, UNC</b>						
P0154-RE05	3/16"	2.75"	1.73"	0.38"	300	0.02
P0154-RE07	1/4"	3.15"	2.06"	0.44"	440	0.04
P0154-RE08	5/16"	3.76"	2.53"	0.52"	800	0.08
P0154-RE10	3/8"	5.48"	3.78"	0.67"	1,200	0.18
P0154-RE13	1/2"	5.87"	3.79"	0.78"	2,200	0.35
P0154-RE16	5/8"	7.84"	5.35"	0.87"	2,800	0.73
P0154-RE20	3/4"	9.16"	6.28"	1.15"	3,500	1.30
<b>LEFT HAND, UNC</b>						
P0154-LE05	3/16"	2.75"	1.73"	0.38"	300	0.02
P0154-LE07	1/4"	3.15"	2.06"	0.44"	440	0.04
P0154-LE08	5/16"	3.76"	2.53"	0.52"	800	0.08
P0154-LE10	3/8"	5.48"	3.78"	0.67"	1,200	0.18
P0154-LE13	1/2"	5.87"	3.79"	0.78"	2,200	0.35
P0154-LE16	5/8"	7.84"	5.35"	0.87"	2,800	0.73
P0154-LE20	3/4"	9.16"	6.28"	1.15"	3,500	1.30

**NOTE:**  
USE WITH "OPEN" TURNBUCKLE BODY (P0105-BD, PAGE 24).

## TURNBUCKLE HOOK UNC THREAD - 316 STAINLESS STEEL

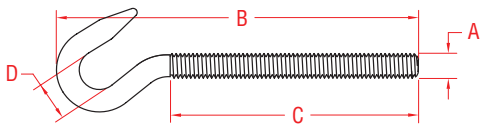

ITEM	A	B	C	D	WLL	WT
	(size)				(lb)	(lb)
<b>RIGHT HAND, UNC</b>						
P0154-RH05	3/16"	2.70"	1.78"	0.30"	100	0.02
P0154-RH07	1/4"	3.18"	2.05"	0.38"	200	0.04
P0154-RH08	5/16"	3.97"	2.52"	0.45"	400	0.08
P0154-RH10	3/8"	5.41"	3.71"	0.52"	700	0.16
P0154-RH13	1/2"	5.80"	3.65"	0.56"	1,000	0.33
P0154-RH16	5/8"	8.00"	5.45"	0.75"	1,500	0.66
P0154-RH20	3/4"	8.88"	5.92"	0.97"	2,000	1.12
<b>LEFT HAND, UNC</b>						
P0154-LH05	3/16"	2.70"	1.78"	0.30"	100	0.02
P0154-LH07	1/4"	3.18"	2.05"	0.38"	200	0.04
P0154-LH08	5/16"	3.97"	2.52"	0.45"	400	0.08
P0154-LH10	3/8"	5.41"	3.71"	0.52"	700	0.16
P0154-LH13	1/2"	5.80"	3.65"	0.56"	1,000	0.33
P0154-LH16	5/8"	8.00"	5.45"	0.75"	1,500	0.66
P0154-LH20	3/4"	8.88"	5.92"	0.97"	2,000	1.12

**NOTE:**  
USE WITH "OPEN" TURNBUCKLE BODY (P0105-BD, PAGE 24).



ORDERS ONLY: 800-394-2222  
(USA+CANADA)

Key:

Made in USA	Drop Forged	Precision Machined	Wire Formed	Suncor Exclusive
Import	Precision Cast	Stamped	Load Rated	New Product

All logos, icons, images, measurements and descriptions are the sole property of Suncor Stainless, Inc.  
© 2020 Suncor Stainless, Inc.

## TURNBUCKLE JAW



**UNC THREAD  
316 STAINLESS STEEL**

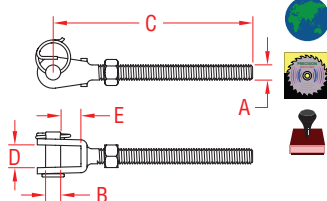

ITEM	A	B	C	D	E	WLL	WT
	(size)					(lb)	(lb)
<b>RIGHT HAND, UNC</b>							
P0101-RJ05	3/16"	0.19"	2.33"	0.37"	0.35"	300	0.04
P0101-RJ07	1/4"	0.23"	2.87"	0.41"	0.38"	440	0.06
P0101-RJ08	5/16"	0.30"	3.53"	0.42"	0.38"	800	0.11
P0101-RJ10	3/8"	0.38"	4.04"	0.54"	0.48"	1,200	0.21
P0101-RJ13	1/2"	0.46"	4.80"	0.71"	0.76"	2,200	0.38
P0101-RJ16	5/8"	0.62"	6.00"	0.73"	0.86"	2,800	0.95
<b>LEFT HAND, UNC</b>							
P0101-LJ05	3/16"	0.19"	2.33"	0.37"	0.35"	300	0.04
P0101-LJ07	1/4"	0.23"	2.87"	0.41"	0.38"	440	0.06
P0101-LJ08	5/16"	0.30"	3.53"	0.42"	0.38"	800	0.11
P0101-LJ10	3/8"	0.38"	4.04"	0.54"	0.48"	1,200	0.21
P0101-LJ13	1/2"	0.46"	4.80"	0.71"	0.76"	2,200	0.38
P0101-LJ16	5/8"	0.62"	6.00"	0.73"	0.86"	2,800	0.95

**NOTE:**  
USE WITH "CLOSED" TURNBUCKLE BODY (P0101-BD, PAGE 24).

## TURNBUCKLE JAW



**UNC THREAD  
316 STAINLESS STEEL**

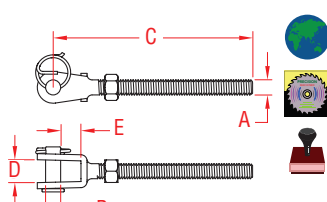

ITEM	A	B	C	D	E	WLL	WT
	(size)					(lb)	(lb)
<b>RIGHT HAND, UNC</b>							
P0105-RJ05	3/16"	0.19"	2.33"	0.37"	0.35"	300	0.04
P0105-RJ07	1/4"	0.23"	2.87"	0.41"	0.38"	440	0.06
P0105-RJ08	5/16"	0.30"	3.53"	0.42"	0.38"	800	0.11
P0105-RJ10	3/8"	0.38"	4.98"	0.54"	0.48"	1,200	0.23
P0105-RJ13	1/2"	0.46"	5.58"	0.71"	0.76"	2,200	0.41
P0105-RJ16	5/8"	0.62"	7.35"	0.73"	0.86"	2,800	0.96
P0105-RJ20	3/4"	0.75"	9.04"	0.86"	1.15"	3,500	1.56
<b>LEFT HAND, UNC</b>							
P0105-LJ05	3/16"	0.19"	2.33"	0.37"	0.35"	300	0.04
P0105-LJ07	1/4"	0.23"	2.87"	0.41"	0.38"	440	0.06
P0105-LJ08	5/16"	0.30"	3.53"	0.42"	0.38"	800	0.11
P0105-LJ10	3/8"	0.38"	4.98"	0.54"	0.48"	1,200	0.23
P0105-LJ13	1/2"	0.46"	5.58"	0.71"	0.76"	2,200	0.41
P0105-LJ16	5/8"	0.62"	7.35"	0.73"	0.86"	2,800	0.96
P0105-LJ20	3/4"	0.75"	9.04"	0.86"	1.15"	3,500	1.56

**NOTE:**  
USE WITH "OPEN" TURNBUCKLE BODY (P0105-BD, PAGE 24).

## TURNBUCKLE JAW



**UNF THREAD  
316 STAINLESS STEEL**

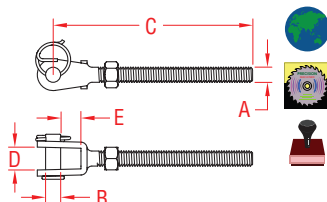

ITEM	A	B	C	D	E	WLL	WT
	(size)					(lb)	(lb)
<b>RIGHT HAND, UNF</b>							
P0780-RJ05	3/16"	0.19"	2.39"	0.34"	0.36"	300	0.04
P0780-RJ07	1/4"	0.23"	3.19"	0.38"	0.40"	440	0.07
P0780-RJ09	5/16"	0.31"	3.35"	0.42"	0.38"	800	0.11
P0780-RJ10	3/8"	0.37"	3.70"	0.47"	0.51"	1,200	0.19
P0780-RJ13	1/2"	0.47"	4.71"	0.61"	0.74"	2,200	0.39
P0780-RJ16	5/8"	0.62"	6.02"	0.68"	1.00"	2,800	0.86
<b>LEFT HAND, UNF</b>							
P0780-LJ05	3/16"	0.19"	2.39"	0.34"	0.36"	300	0.04
P0780-LJ07	1/4"	0.23"	3.19"	0.38"	0.40"	440	0.07
P0780-LJ09	5/16"	0.31"	3.35"	0.42"	0.38"	800	0.11
P0780-LJ10	3/8"	0.37"	3.70"	0.47"	0.51"	1,200	0.19
P0780-LJ13	1/2"	0.47"	4.71"	0.61"	0.74"	2,200	0.39
P0780-LJ16	5/8"	0.62"	6.02"	0.68"	1.00"	2,800	0.86

**NOTE:**  
USE WITH "CLOSED" TURNBUCKLE BODY (P0780-BD, PAGE 24).

## TURNBUCKLE WALL TOGGLE



**UNF THREAD  
316 STAINLESS STEEL**

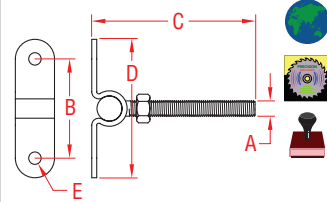

ITEM	A	B	C	D	E	WT
	(size)					(lb)
<b>RIGHT HAND, UNF</b>						
P0770-WT07	1/4"	1.62"	2.98"	2.16"	0.24"	0.09
P0770-WT09	5/16"	2.00"	3.29"	2.80"	0.31"	0.16
P0770-WT10	3/8"	2.22"	3.61"	3.10"	0.39"	0.23
<b>LEFT HAND, UNF</b>						
P0776-WT07	1/4"	1.62"	2.98"	2.16"	0.24"	0.09
P0776-WT09	5/16"	2.00"	3.29"	2.80"	0.31"	0.16
P0776-WT10	3/8"	2.22"	3.61"	3.10"	0.39"	0.23

**NOTE:**  
USE WITH "CLOSED" TURNBUCKLE BODY (P0780-BD, PAGE 24).  
REFERENCE "FASTENER MATCHING CHART" (PAGE 164) FOR COMPATIBLE FASTENERS.

**LIMITED LIFETIME  
WARRANTY**

**SUNCOR STAINLESS®**

TEL 508-732-9191 • FAX 508-732-9798 • ORDERS ONLY 800-394-2222

www.suncorstainless.com