

SUNCOR STAINLESS, INC.

SWAGE TERMINALS

Mil. Spec
Machine Swage
Hand Swage



 SUNCOR[®]
Stainless

MIL. SPEC

We have now joined the elite rankings of companies in the U.S. Government's Quality Manufacturer's List (QML). After extensive technology investments, manufacturing and testing, we have met the government's quality and testing requirements for aircraft control cable terminals and assemblies. We are now listed in QML-6117 and QPL-781 for these specific components.



**Mil. Spec Products
Manufactured at
our Plymouth, MA Facility.**

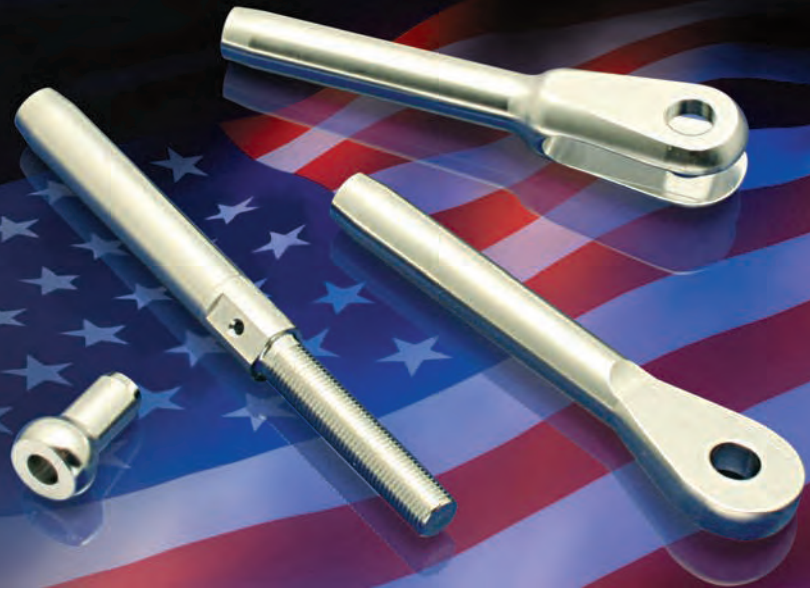

The U.S. Government has approved Suncor Stainless for the manufacturing of aircraft control cable terminals and assemblies per MIL-DTL-781. These qualifications have been sought to expand our current offerings to the highest quality rated products. In addition to meeting these Mil. Spec requirements, we have risen Suncor's already high standard of quality.

QUALITY PRODUCTS & SERVICE

The qualifying process started in February 2010, when representatives from the Defense Supply Center, Standardization Program Branch, Aviation Division visited Suncor Stainless to inspect the manufacturing and quality processes for over 40 corrosion resistant steel swage terminals. Under the supervision of the government inspectors, each part was measured and tested to meet the requirements of MIL-DTL-6117 and MIL-DTL-781.

MIL. SPEC PRODUCTS

These qualified stainless steel swage components that are now listed in QPL-781 are left hand and right hand thread Swage Studs (MS21259), Swage Eyes (MS20668), Swage Forks (MS20667), Double Shank Balls (MS20663C) and Single Shank Balls (MS20664C), with sizes ranging from 1/16" to 3/8".



Precision Manufacturing

Suncor has moved aggressively into the domestic manufacturing of Mil. Spec hardware using the new Citizen Swiss Style Screw Machine and the Euro Tech High Speed CNC Lathe.



Cable Assemblies

Per MIL-DTL-6117, we have the ability to produce quality stainless steel aircraft control cable assemblies.



Product Testing

We have expanded our wire rope shop to incorporate a large test bed to allow for the testing of long wire rope assemblies per MIL-DTL-6117.

**LIMITED LIFETIME
WARRANTY**

 **SUNCOR STAINLESS®**

TEL 508-732-9191 • FAX 508-732-9798 • ORDERS ONLY 800-394-2222
www.suncorstainless.com

MIL. SPEC SWAGE EYE



STAINLESS STEEL

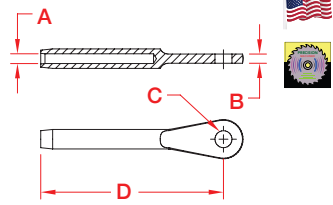

ITEM	A	B	C	D	BEFORE	AFTER	WT
	(wire)				(swage)	(swage)	(lb)
MS20668-2	1/16"	0.09"	0.19"	1.63"	0.160"	0.138"	0.01
MS20668-3	3/32"	0.10"	0.19"	2.04"	0.218"	0.190"	0.02
MS20668-4	1/8"	0.19"	0.19"	2.34"	0.250"	0.219"	0.03
MS20668-5	5/32"	0.20"	0.25"	2.68"	0.297"	0.250"	0.05
MS20668-6	3/16"	0.26"	0.31"	3.02"	0.359"	0.313"	0.09
MS20668-8	1/4"	0.31"	0.38"	3.76"	0.494"	0.438"	0.19
MS20668-10	5/16"	0.34"	0.44"	4.55"	0.635"	0.563"	0.37
MS20668-12	3/8"	0.38"	0.50"	5.56"	0.703"	0.625"	0.58

NOTE: THESE FITTINGS MEET MIL SPEC #MS20668 AND HAVE MET ALL QUALITY AND TESTING REQUIREMENTS PER MIL-DTL-781 AND ARE APPROVED FOR LISTING IN QPL-781. MACHINE SWAGE ONLY.

MIL.SPEC

MIL. SPEC SWAGE FORK



STAINLESS STEEL

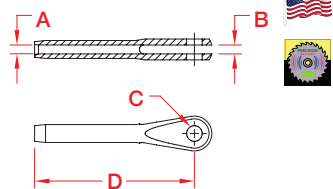

ITEM	A	B	C	D	BEFORE	AFTER	WT
	(wire)				(swage)	(swage)	(lb)
MS20667-2	1/16"	0.09"	0.19"	1.57"	0.160"	0.138"	0.01
MS20667-3	3/32"	0.11"	0.19"	1.95"	0.218"	0.190"	0.02
MS20667-4	1/8"	0.20"	0.19"	2.35"	0.250"	0.219"	0.03
MS20667-5	5/32"	0.20"	0.25"	2.67"	0.297"	0.250"	0.04
MS20667-6	3/16"	0.26"	0.31"	3.07"	0.359"	0.313"	0.09
MS20667-8	1/4"	0.31"	0.38"	3.81"	0.494"	0.438"	0.21
MS20667-10	5/16"	0.35"	0.44"	4.44"	0.635"	0.563"	0.40
MS20667-12	3/8"	0.38"	0.50"	5.33"	0.703"	0.625"	0.58

NOTE: THESE FITTINGS MEET MIL SPEC #MS20667 AND HAVE MET ALL QUALITY AND TESTING REQUIREMENTS PER MIL-DTL-781 AND ARE APPROVED FOR LISTING IN QPL-781. MACHINE SWAGE ONLY.

MIL.SPEC

CLEVIS PIN



304 STAINLESS STEEL

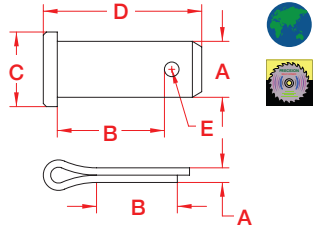

ITEM	A	B	C	D	E	WT
	(size)					(lb)
CLEVIS PIN						
P0116-RP0508	3/16"	0.31"	0.31"	0.50"	0.081"	0.004
P0116-RP0510	3/16"	0.41"	0.31"	0.59"	0.081"	0.005
P0116-RP0610	1/4"	0.41"	0.38"	0.59"	0.089"	0.009
P0116-RP0813	5/16"	0.56"	0.44"	0.78"	0.098"	0.017
P0116-RP1022	3/8"	0.81"	0.50"	1.06"	0.098"	0.033
P0116-RP1222	7/16"	0.88"	0.63"	1.19"	0.141"	0.040
P0116-RP1325	1/2"	1.00"	0.69"	1.34"	0.141"	0.050

COTTER PIN, 18-8 STAINLESS STEEL

P0116-CT01	1/16"	0.75"	(For use w/ Clevis Pins: -RP0508, -RP0510 & -RP0610)
P0116-CT07	3/32"	0.75"	(For use w/ Clevis Pins: -RP0813 & -RP1022)
P0116-CT13	1/8"	1.25"	(For use w/ Clevis Pins: -RP1222 & -RP1325)

MIL. SPEC SWAGE STUD



UNF THREAD
STAINLESS STEEL

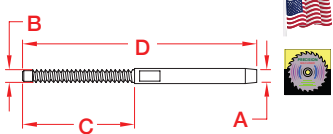

ITEM	A	B	C	D	E	WT
	(wire)	(thread)			(wrench flat)	(lb)
RIGHT HAND, UNF						
MS21259-2RH	1/16"	0.14"	1.05"	2.47"	0.16"	0.01
MS21259-3RH	3/32"	0.19"	1.20"	2.88"	0.19"	0.02
MS21259-4RH	1/8"	0.25"	1.38"	3.33"	0.25"	0.04
MS21259-5RH	5/32"	0.25"	1.38"	3.63"	0.25"	0.05
MS21259-6RH	3/16"	0.31"	1.45"	4.00"	0.31"	0.08
MS21259-8RH	1/4"	0.38"	1.75"	4.94"	0.44"	0.17
MS21259-10RH	5/16"	0.50"	2.00"	5.84"	0.63"	0.38
MS21259-12RH	3/8"	0.56"	2.25"	6.66"	0.69"	0.50

LEFT HAND, UNF

MS21259-2LH	1/16"	0.14"	1.05"	2.47"	0.16"	0.01
MS21259-3LH	3/32"	0.19"	1.20"	2.88"	0.19"	0.02
MS21259-4LH	1/8"	0.25"	1.38"	3.33"	0.25"	0.04
MS21259-5LH	5/32"	0.25"	1.38"	3.63"	0.25"	0.05
MS21259-6LH	3/16"	0.31"	1.45"	4.00"	0.31"	0.08
MS21259-8LH	1/4"	0.38"	1.75"	4.94"	0.44"	0.17
MS21259-10LH	5/16"	0.50"	2.00"	5.84"	0.63"	0.38
MS21259-12LH	3/8"	0.56"	2.25"	6.66"	0.69"	0.50

NOTE:

THESE FITTINGS MEET MIL SPEC #MS21259 AND HAVE MET ALL QUALITY AND TESTING REQUIREMENTS PER MIL-DTL-781 AND ARE APPROVED FOR LISTING IN QPL-781. ALL THREADS ARE "UNF". MACHINE SWAGE ONLY.

MIL.SPEC



ORDERS ONLY: 800-394-2222
(USA+CANADA)

Key:



Made in USA



Drop Forged



Precision Machined



Wire Formed



Suncor Exclusive



Import



Precision Cast



Stamped



Load Rated



New Product

All logos, icons, images, measurements and descriptions are the sole property of Suncor Stainless, Inc.

© 2020 Suncor Stainless, Inc.

MIL. SPEC SPECIAL EYE

STAINLESS STEEL

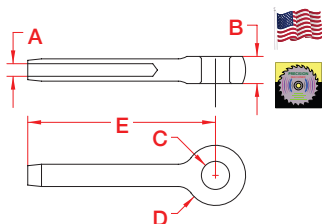

ITEM	A	B	C	D	E	WT
	(wire)					(lb)
RA-3266-6	3/16"	0.44"	0.45"	0.97"	3.02"	0.12

NOTE:
THIS FITTING HAS MET ALL QUALITY AND TESTING REQUIREMENTS PER MIL-DTL-781 AND ARE APPROVED FOR LISTING IN QPL-781. MACHINE SWAGE ONLY.

MIL.SPEC

MIL. SPEC SINGLE SHANK BALL

STAINLESS STEEL

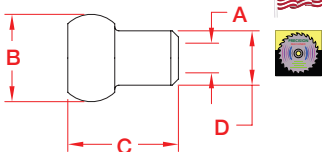

ITEM	A	B BEFORE	B AFTER	C	D BEFORE	D AFTER	WT
	(wire)	(swage)	(swage)		(swage)	(swage)	(lb)
MS20664C2	1/16"	0.212"	0.190"	0.27"	0.132"	0.112"	0.01
MS20664C3	3/32"	0.282"	0.253"	0.38"	0.168"	0.143"	0.01
MS20664C4	1/8"	0.350"	0.315"	0.50"	0.223"	0.190"	0.01
MS20664C5	5/32"	0.424"	0.379"	0.62"	0.259"	0.222"	0.01
MS20664C6	3/16"	0.492"	0.442"	0.73"	0.298"	0.255"	0.01
MS20664C7	7/32"	0.560"	0.505"	0.85"	0.352"	0.302"	0.02
MS20664C8	1/4"	0.629"	0.567"	0.96"	0.406"	0.348"	0.02
MS20664C10	5/16"	0.768"	0.694"	1.19"	0.480"	0.413"	0.06

NOTE: THESE FITTINGS MEET MIL SPEC #MS20664 AND HAVE MET ALL QUALITY AND TESTING REQUIREMENTS PER MIL-DTL-781 AND ARE APPROVED FOR LISTING IN QPL-781. MACHINE SWAGE ONLY.

MIL.SPEC

MIL. SPEC DOUBLE SHANK BALL

STAINLESS STEEL

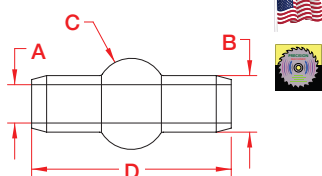

ITEM	A	B BEFORE	B AFTER	C BEFORE	C AFTER	D	WT
	(wire)	(swage)	(swage)	(swage)	(swage)		(lb)
MS20663C2	1/16"	0.127"	0.112"	0.207"	0.190"	0.36"	0.001
MS20663C3	3/32"	0.163"	0.143"	0.277"	0.253"	0.53"	0.003
MS20663C4	1/8"	0.218"	0.190"	0.345"	0.315"	0.69"	0.01
MS20663C5	5/32"	0.254"	0.222"	0.419"	0.379"	0.85"	0.01
MS20663C6	3/16"	0.293"	0.255"	0.487"	0.442"	1.01"	0.02
MS20663C7	7/32"	0.347"	0.302"	0.555"	0.505"	1.18"	0.03
MS20663C8	1/4"	0.401"	0.348"	0.624"	0.567"	1.34"	0.04
MS20663C10	5/16"	0.475"	0.413"	0.763"	0.694"	1.66"	0.07

NOTE:
THESE FITTINGS MEET MIL SPEC #MS20663 AND HAVE MET ALL QUALITY AND TESTING REQUIREMENTS PER MIL-DTL-781.

MIL.SPEC

SWAGE "T" TERMINAL

316 STAINLESS STEEL

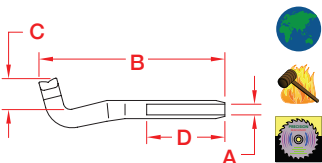

ITEM	A	B	C	D	BEFORE	AFTER	WT
	(wire)				(swage)	(swage)	(lb)
S0742-0002	3/32"	2.76"	0.51"	1.26"	0.218"	0.190"	0.05
S0742-0003	1/8"	3.03"	0.51"	1.53"	0.250"	0.219"	0.07
S0742-0004	5/32"	3.74"	0.51"	1.77"	0.297"	0.250"	0.09
S0742-0005	3/16"	3.98"	0.59"	2.05"	0.359"	0.313"	0.12
S0742-0006	7/32"	5.12"	0.79"	2.28"	0.427"	0.375"	0.30
S0742-0007	1/4"	5.12"	0.79"	2.52"	0.494"	0.438"	0.30
S0742-0008	9/32"	5.35"	0.79"	2.79"	0.563"	0.500"	0.40
S0742-0009	5/16"	6.61"	0.91"	3.03"	0.635"	0.563"	0.66
S0742-0010	3/8"	7.58"	0.95"	3.80"	0.708"	0.628"	0.79

"T" - PLATE

316 STAINLESS STEEL

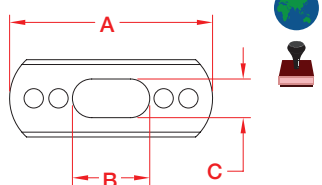

ITEM	FITS SIZE	A	B	C	WT
					(lb)
S0743-0003	3/32" - 1/8"	1.97"	0.51"	0.28"	0.02
S0743-0005	5/32" - 3/16"	3.47"	1.04"	0.38"	0.08
S0743-0007	7/32" - 1/4" - 9/32"	4.84"	1.36"	0.61"	0.21
S0743-0010	5/16" - 3/8"	5.94"	1.61"	0.75"	0.50

NOTE:
REFERENCE "FASTENER MATCHING CHART" (PAGE 164) FOR COMPATIBLE FASTENERS.

LIMITED LIFETIME WARRANTY

SUNCOR STAINLESS®

TEL 508-732-9191 • FAX 508-732-9798 • ORDERS ONLY 800-394-2222
www.suncorstainless.com

LIFELINE ADJUSTER 316 STAINLESS STEEL

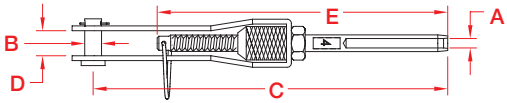

ITEM	A	B	C	D	E	WT
	(size)					(lb)
S0745-0003	1/8"	0.24"	5.25"	0.42"	4.35"	0.16
S0745-0004	5/32"	0.24"	5.67"	0.42"	4.70"	0.18
S0745-0005	3/16"	0.24"	5.89"	0.42"	4.97"	0.20

NOTE:
TENSIONER DESIGNED FOR, BUT NOT LIMITED TO, LIFELINE APPLICATIONS. MACHINE SWAGE ONLY.

HAND SWAGE VERSION OF THIS ITEM AVAILABLE ON PAGE 40.

GATE TERMINALS 316 STAINLESS STEEL

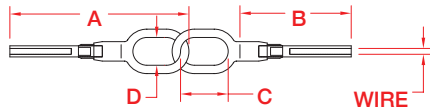

ITEM	SIZE	WIRE	A	B	C	D	WT
							(lb)
GATE EYE							
S0744-0003	1/8"	1/8"	4.07"	2.36"	1.05"	0.59"	0.09
S0744-0004	5/32"	5/32"	4.41"	2.70"	1.05"	0.59"	0.10
S0744-0005	3/16"	3/16"	4.71"	3.00"	1.05"	0.59"	0.12
JOINED GATE EYES							
S0746-0003	1/8"	1/8"	4.07"	2.36"	1.05"	0.59"	0.15
S0746-0004	5/32"	5/32"	4.41"	2.70"	1.05"	0.59"	0.16
S0746-0005	3/16"	3/16"	4.71"	3.00"	1.05"	0.59"	0.19

NOTE:
PRECISION CAST, THEN WELDED. MACHINE SWAGE ONLY.

HAND SWAGE VERSION OF THIS ITEM AVAILABLE ON PAGE 41.

SWIVEL GATE TERMINALS 316 STAINLESS STEEL

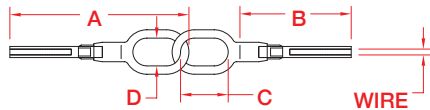

ITEM	SIZE	WIRE	A	B	C	D	WT
							(lb)
SWIVEL GATE EYE							
S0718-0003	1/8"	1/8"	3.77"	2.34"	0.84"	0.59"	0.07
S0718-0004	5/32"	5/32"	4.12"	2.68"	0.84"	0.59"	0.08
S0718-0005	3/16"	3/16"	4.41"	2.97"	0.84"	0.59"	0.10
JOINED SWIVEL GATE EYES							
S0719-0003	1/8"	1/8"	3.77"	2.34"	0.84"	0.59"	0.15
S0719-0004	5/32"	5/32"	4.12"	2.68"	0.84"	0.59"	0.16
S0719-0005	3/16"	3/16"	4.41"	2.97"	0.84"	0.59"	0.19

NOTE:
PRECISION CAST, THEN WELDED. MACHINE SWAGE ONLY.

HAND SWAGE VERSION OF THIS ITEM AVAILABLE ON PAGE 41.

PELICAN HOOK 316 STAINLESS STEEL

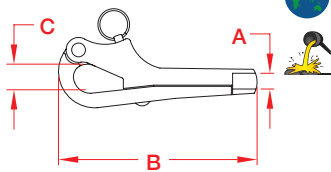

ITEM	A	B	C	WT
	(thread)			(lb)
S0162-0007	1/4"	2.96"	0.50"	0.16
S0162-0008	5/16"	3.87"	0.64"	0.28
S0162-0013	1/2"	6.00"	1.00"	0.92

NOTE:
ALL THREADS ARE RIGHT HAND "UNF". OTHER COMBINATIONS ARE AVAILABLE. PLEASE CALL WITH YOUR SPECIFICATIONS. PELICAN HOOK WITH SLIDE IS ITEM #S0180 IN HOOKS ON PAGE 67.

PELICAN HOOK W/ SWAGE STUD 316 STAINLESS STEEL

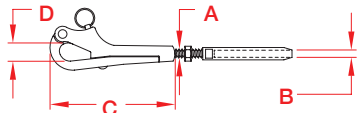

ITEM	A	B	C	D	WT
	(thread)	(wire)			(lb)
S0162-A007	1/4"	1/8"	2.96"	0.50"	0.20
S0162-A008	5/16"	3/16"	3.87"	0.64"	0.37
S0162-A013	1/2"	1/4"	6.00"	1.00"	1.19

NOTE:
ALL THREADS ARE RIGHT HAND "UNF". S0731-SERIES SWAGE STUDS ARE USED FOR THIS ASSEMBLY. INFORMATION REGARDING THE S0731-SERIES CAN BE FOUND ON PAGE 34. MACHINE SWAGE ONLY.

HAND SWAGE VERSION OF THIS ITEM AVAILABLE ON PAGE 40.



Key:

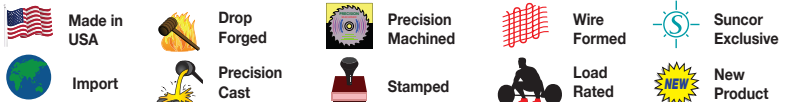

ORDERS ONLY: 800-394-2222
(USA+CANADA)

TURNBUCKLE WALL MOUNT & SWAGE 316 STAINLESS STEEL

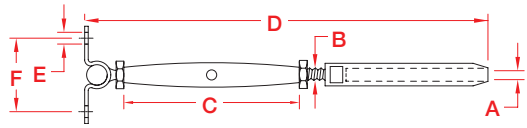

ITEM	A	B	C	D	E	F	WT
	(size)						(lb)
S0784-0703	1/8"	1/4"	4.20"	7.25"	0.25"	1.58"	0.25
S0784-0704	5/32"	1/4"	4.20"	7.50"	0.25"	1.58"	0.28
S0784-0705	3/16"	1/4"	4.20"	8.00"	0.25"	1.58"	0.32

NOTE:
THREADS ARE "UNF". MACHINE SWAGE ONLY.
TURNBUCKLES WITH QUICK ATTACH™ FITTINGS ARE SHOWN ON PAGE 47.
HAND SWAGE VERSION OF THIS ITEM AVAILABLE ON PAGE 39.

REFERENCE "FASTENER MATCHING CHART"
(PAGE 164) FOR COMPATIBLE FASTENERS.

TURNBUCKLE JAW & SWAGE 316 STAINLESS STEEL

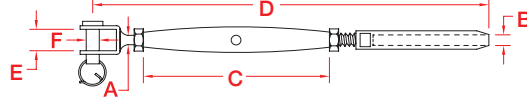

ITEM	A	B	C	D	E	F	WT
	(size)	(wire)					(lb)
S0781-0703	1/4"	1/8"	4.20"	7.50"	0.38"	0.22"	0.19
S0781-0704	1/4"	5/32"	4.20"	7.75"	0.38"	0.22"	0.21
S0781-0705	1/4"	3/16"	4.25"	8.25"	0.38"	0.22"	0.23
S0781-0904	5/16"	5/32"	4.32"	8.19"	0.40"	0.30"	0.35
S0781-0905	5/16"	3/16"	4.32"	8.56"	0.40"	0.30"	0.37
S0781-1005	3/8"	3/16"	4.90"	9.25"	0.46"	0.37"	0.53
S0781-1007	3/8"	1/4"	4.90"	10.00"	0.46"	0.37"	0.60
S0781-1307	1/2"	1/4"	5.87"	11.87"	0.59"	0.46"	1.09
S0781-1309	1/2"	5/16"	5.87"	12.62"	0.59"	0.46"	1.21
S0781-1610	5/8"	3/8"	7.48"	15.00"	0.70"	0.55"	2.50
S0781-2013	3/4"	1/2"	8.66"	17.40"	0.94"	0.75"	4.20

NOTE: OTHER CONFIGURATIONS ARE AVAILABLE.
THREADS ARE "UNF". MACHINE SWAGE ONLY.

TURNBUCKLE TOGGLE & SWAGE 316 STAINLESS STEEL

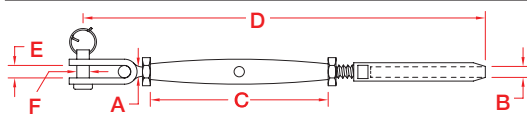

ITEM	A	B	C	D	E	F	WT
	(size)	(wire)					(lb)
S0782-0501	3/16"	1/16"	3.56"	6.62"	0.26"	0.19"	0.14
S0782-0502	3/16"	3/32"	3.56"	6.87"	0.26"	0.19"	0.14
S0782-0702	1/4"	3/32"	4.20"	7.62"	0.35"	0.23"	0.22
S0782-0703	1/4"	1/8"	4.20"	7.87"	0.35"	0.23"	0.25
S0782-0704	1/4"	5/32"	4.20"	8.12"	0.35"	0.23"	0.27
S0782-0705	1/4"	3/16"	4.20"	8.64"	0.35"	0.23"	0.29
S0782-0904	5/16"	5/32"	4.32"	8.56"	0.40"	0.31"	0.40
S0782-0905	5/16"	3/16"	4.32"	9.00"	0.40"	0.31"	0.43
S0782-1005	3/8"	3/16"	4.90"	9.75"	0.56"	0.37"	0.64
S0782-1007	3/8"	1/4"	4.90"	10.44"	0.56"	0.37"	0.69
S0782-1307	1/2"	1/4"	5.87"	12.25"	0.63"	0.47"	1.32
S0782-1309	1/2"	5/16"	5.87"	13.00"	0.63"	0.47"	1.50
S0782-1610	5/8"	3/8"	7.50"	17.00"	0.80"	0.62"	2.69

NOTE: OTHER CONFIGURATIONS ARE AVAILABLE. BODIES ONLY
ON PAGE 24. THREADS ARE "UNF". MACHINE SWAGE ONLY.

TURNBUCKLE TOGGLE & SWAGE CHROMED BRONZE BODY & STAINLESS ENDS

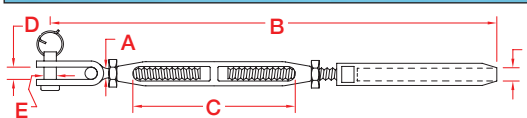

ITEM	A	B	C	D	E	F	WT
	(size)		(adjustment)			(wire)	(lb)
S0786-0703	1/4"	8.37"	3.50"	0.35"	0.23"	1/8"	0.27
S0786-0704	1/4"	8.81"	3.50"	0.35"	0.23"	5/32"	0.28
S0786-0705	1/4"	8.87"	3.50"	0.35"	0.23"	3/16"	0.32
S0786-0904	5/16"	9.25"	3.80"	0.40"	0.31"	5/32"	0.42
S0786-0905	5/16"	9.62"	3.80"	0.40"	0.31"	3/16"	0.44
S0786-1005	3/8"	11.50"	4.40"	0.56"	0.37"	3/16"	0.77
S0786-1006	3/8"	11.50"	4.40"	0.56"	0.37"	7/32"	0.79
S0786-1007	3/8"	11.50"	4.40"	0.56"	0.37"	1/4"	0.81
S0786-1307	1/2"	13.00"	4.62"	0.63"	0.47"	1/4"	1.48
S0786-1308	1/2"	13.25"	4.62"	0.63"	0.47"	9/32"	1.50
S0786-1309	1/2"	13.75"	4.62"	0.63"	0.47"	5/16"	1.50
S0786-1610	5/8"	17.31"	6.06"	0.79"	0.62"	3/8"	3.14

NOTE: THREADS ARE "UNF". MACHINE SWAGE ONLY.
HAND SWAGE VERSION OF THIS ITEM AVAILABLE ON PAGE 39.

TURNBUCKLE TOGGLE & SWAGE BRONZE BODY & STAINLESS ENDS

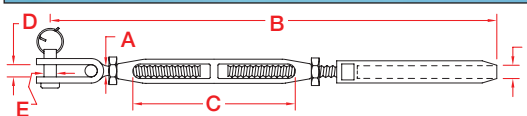

ITEM	A	B	C	D	E	F	WT
	(size)		(adjustment)			(wire)	(lb)
S0789-0703	1/4"	8.37"	3.50"	0.35"	0.23"	1/8"	0.27
S0789-0704	1/4"	8.81"	3.50"	0.35"	0.23"	5/32"	0.28
S0789-0705	1/4"	8.87"	3.50"	0.35"	0.23"	3/16"	0.32
S0789-0904	5/16"	9.25"	3.80"	0.40"	0.31"	5/32"	0.42
S0789-0905	5/16"	9.62"	3.80"	0.40"	0.31"	3/16"	0.44
S0789-1005	3/8"	11.50"	4.40"	0.56"	0.37"	3/16"	0.63
S0789-1007	3/8"	11.50"	4.40"	0.56"	0.37"	1/4"	0.67
S0789-1307	1/2"	13.00"	4.62"	0.63"	0.47"	1/4"	1.48
S0789-1308	1/2"	13.25"	4.62"	0.63"	0.47"	9/32"	1.50
S0789-1309	1/2"	13.75"	4.62"	0.63"	0.47"	5/16"	1.50
S0789-1610	5/8"	17.31"	6.06"	0.79"	0.62"	3/8"	3.14

NOTE: THREADS ARE "UNF". OTHER CONFIGURATIONS,
SUCH AS TOGGLE/TOGGLE ARE AVAILABLE.

**LIMITED LIFETIME
WARRANTY**

SUNCOR STAINLESS®

TEL 508-732-9191 • FAX 508-732-9798 • ORDERS ONLY 800-394-2222
www.suncorstainless.com

SWAGE STUD

**UNF, RIGHT HAND
316 STAINLESS STEEL**

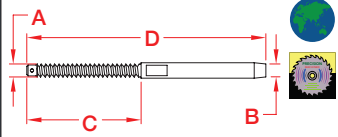

ITEM	A	B	C	D	BEFORE	AFTER	WT
	(thread)	(wire)			(swage)	(swage)	(lb)
S0731-0501	3/16"	1/16"	1.69"	3.37"	0.160"	0.138"	0.02
S0731-0502	3/16"	3/32"	1.75"	3.62"	0.218"	0.190"	0.03
S0731-0702	1/4"	3/32"	2.25"	4.12"	0.218"	0.190"	0.05
S0731-0703	1/4"	1/8"	2.20"	4.32"	0.250"	0.219"	0.05
S0731-0704	1/4"	5/32"	2.15"	4.64"	0.297"	0.250"	0.06
S0731-0705	1/4"	3/16"	2.19"	4.94"	0.359"	0.313"	0.09
S0731-0904	5/16"	5/32"	2.12"	4.84"	0.297"	0.250"	0.09
S0731-0905	5/16"	3/16"	2.50"	5.12"	0.359"	0.313"	0.11
S0731-1005	3/8"	3/16"	2.68"	5.12"	0.359"	0.313"	0.14
S0731-1006	3/8"	7/32"	2.72"	5.50"	0.427"	0.376"	0.17
S0731-1007	3/8"	1/4"	2.75"	5.87"	0.494"	0.438"	0.21
S0731-1307	1/2"	1/4"	3.00"	6.43"	0.494"	0.438"	0.31
S0731-1308	1/2"	9/32"	3.10"	6.73"	0.563"	0.500"	0.37
S0731-1309	1/2"	5/16"	3.12"	7.31"	0.635"	0.563"	0.47
S0731-1610	5/8"	3/8"	4.00"	8.69"	0.703"	0.625"	0.74
S0731-2013	3/4"	1/2"	4.75"	10.25"	0.844"	0.750"	1.17

SWAGE STUD

**UNF, LEFT HAND
316 STAINLESS STEEL**

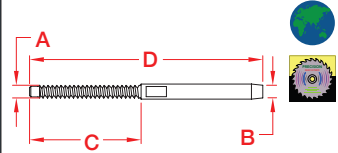

ITEM	A	B	C	D	BEFORE	AFTER	WT
	(thread)	(wire)			(swage)	(swage)	(lb)
S0732-0703	1/4"	1/8"	2.20"	4.32"	0.250"	0.219"	0.05
S0732-0704	1/4"	5/32"	2.15"	4.64"	0.297"	0.250"	0.06
S0732-0705	1/4"	3/16"	2.19"	4.94"	0.359"	0.313"	0.09
S0732-0904	5/16"	5/32"	2.42"	4.84"	0.359"	0.313"	0.09
S0732-0905	5/16"	3/16"	2.50"	5.12"	0.359"	0.313"	0.11
S0732-1005	3/8"	3/16"	2.68"	4.07"	0.359"	0.313"	0.14
S0732-1007	3/8"	1/4"	2.75"	5.87"	0.494"	0.438"	0.21
S0732-1307	1/2"	1/4"	3.00"	6.43"	0.494"	0.438"	0.37
S0732-1309	1/2"	5/16"	3.12"	7.31"	0.635"	0.563"	0.47
S0732-1610	5/8"	3/8"	4.00"	8.69"	0.703"	0.625"	0.74
S0732-2013	3/4"	1/2"	4.75"	10.25"	0.844"	0.750"	1.17

NOTE: S0731-SERIES AND S0732-SERIES ARE FOR MACHINE SWAGE ONLY. FOR PROPER FUNCTIONING, OBSERVE CORRECT "AFTER" DIMENSIONS.

RAIL SWAGE STUD, UNC

316 STAINLESS STEEL

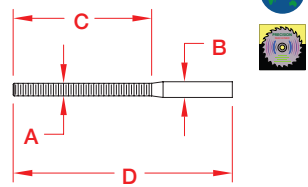

ITEM	A	B	C	D	BEFORE	AFTER	WT
	(thread)	(wire)			(swage)	(swage)	(lb)
RIGHT-UNC							
S0729-0703	1/4" UNC	1/8"	2.25"	4.00"	0.250"	0.219"	0.04
S0729-0704	1/4" UNC	5/32"	2.25"	4.00"	0.297"	0.250"	0.05
S0729-0705	1/4" UNC	3/16"	2.25"	4.00"	0.359"	0.313"	0.06
LEFT-UNC							
S0730-0703	1/4" UNC	1/8"	2.25"	4.00"	0.250"	0.219"	0.04
S0730-0704	1/4" UNC	5/32"	2.25"	4.00"	0.297"	0.250"	0.05
S0730-0705	1/4" UNC	3/16"	2.25"	4.00"	0.359"	0.313"	0.06

NOTE: MACHINE SWAGE ONLY. THIS SLEEK SWAGE STUD IS IDEAL FOR ARCHITECTURAL APPLICATIONS. FOR PROPER FUNCTIONING, OBSERVE CORRECT "AFTER" DIMENSIONS.

RAIL SWAGE STUD, UNF

316 STAINLESS STEEL

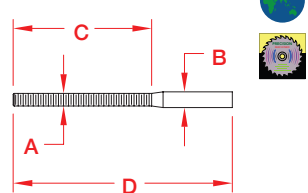

ITEM	A	B	C	D	BEFORE	AFTER	WT
	(thread)	(wire)			(swage)	(swage)	(lb)
RIGHT-UNF							
S0727-0703	1/4" UNF	1/8"	2.25"	4.00"	0.250"	0.219"	0.04
S0727-0704	1/4" UNF	5/32"	2.25"	4.00"	0.297"	0.250"	0.05
S0727-0705	1/4" UNF	3/16"	2.25"	4.00"	0.359"	0.313"	0.06
LEFT-UNF							
S0728-0703	1/4" UNF	1/8"	2.25"	4.00"	0.250"	0.219"	0.04
S0728-0704	1/4" UNF	5/32"	2.25"	4.00"	0.297"	0.250"	0.05
S0728-0705	1/4" UNF	3/16"	2.25"	4.00"	0.359"	0.313"	0.06

NOTE: MACHINE SWAGE ONLY. THIS SLEEK SWAGE STUD IS IDEAL FOR ARCHITECTURAL APPLICATIONS. FOR PROPER FUNCTIONING, OBSERVE CORRECT "AFTER" DIMENSIONS.

MINI SWAGE STUD

**UNC
316 STAINLESS STEEL**

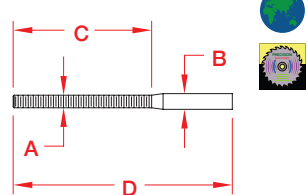

ITEM	A	B	C	D	WIRE	BEFORE	AFTER	WT
	(thread)			(diameter)		(swage)	(swage)	(lb)
LEFT HAND								
S0726-L704	1/4"	0.29"	1.39"	2.63"	5/32"	0.297"	0.250"	0.04
RIGHT HAND								
S0726-R704	1/4"	0.29"	1.39"	2.63"	5/32"	0.297"	0.250"	0.04

NOTE: DESIGNED FOR USE WITH 5/32" DIAMETER WIRE ROPE. IDEAL FOR RAILING APPLICATIONS THAT CALL FOR VERTICAL WIRE ROPE BALUSTERS. SHORTENED STUD LENGTH ALLOWS FOR UNOBSTRUCTED VIEWS AND A STREAMLINED LOOK.



ORDERS ONLY: 800-394-2222 (USA+CANADA)

Key:

Made in USA	Drop Forged	Precision Machined	Wire Formed	Suncor Exclusive
Import	Precision Cast	Stamped	Load Rated	New Product

All logos, icons, images, measurements and descriptions are the sole property of Suncor Stainless, Inc. © 2020 Suncor Stainless, Inc.

SWAGE EYE



316 STAINLESS STEEL

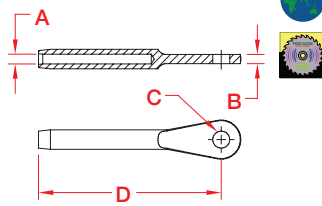

ITEM	A	B	C	D	BEFORE	AFTER	WT
	(wire)				(swage)	(swage)	(lb)
S0733-0001	1/16"	0.09"	0.19"	1.63"	0.160"	0.138"	0.01
S0733-0002	3/32"	0.10"	0.19"	2.04"	0.218"	0.190"	0.02
S0733-0003	1/8"	0.19"	0.19"	2.34"	0.250"	0.219"	0.03
S0733-0004	5/32"	0.19"	0.25"	2.68"	0.297"	0.250"	0.05
S0733-0005	3/16"	0.26"	0.31"	3.02"	0.359"	0.313"	0.09
S0733-0006	7/32"	0.29"	0.31"	3.38"	0.427"	0.375"	0.14
S0733-0007	1/4"	0.31"	0.38"	3.76"	0.494"	0.438"	0.19
S0733-0009	5/16"	0.34"	0.44"	4.55"	0.635"	0.563"	0.37
S0733-0010	3/8"	0.38"	0.50"	5.56"	0.703"	0.625"	0.56
S0733-0013	1/2"	0.47"	0.63"	7.32"	0.844"	0.750"	1.04

NOTE: MACHINE SWAGE ONLY. DESIGNED TO MATE WITH S0734-SERIES SWAGE JAWS (BELOW).

SWAGE JAW



316 STAINLESS STEEL

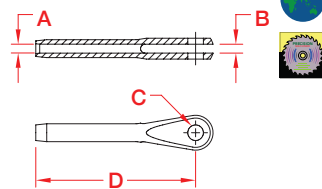

ITEM	A	B	C	D	BEFORE	AFTER	WT
	(wire)				(swage)	(swage)	(lb)
S0734-0001	1/16"	0.09"	0.19"	1.57"	0.160"	0.138"	0.01
S0734-0002	3/32"	0.11"	0.19"	1.95"	0.218"	0.190"	0.02
S0734-0003	1/8"	0.20"	0.19"	2.35"	0.250"	0.219"	0.03
S0734-0004	5/32"	0.20"	0.25"	2.66"	0.297"	0.250"	0.05
S0734-0005	3/16"	0.26"	0.31"	3.07"	0.359"	0.313"	0.09
S0734-0006	7/32"	0.30"	0.31"	3.44"	0.427"	0.375"	0.13
S0734-0007	1/4"	0.31"	0.38"	3.81"	0.494"	0.438"	0.21
S0734-0009	5/16"	0.35"	0.44"	4.44"	0.635"	0.563"	0.40
S0734-0010	3/8"	0.38"	0.50"	5.33"	0.703"	0.625"	0.62
S0734-0013	1/2"	0.47"	0.63"	6.94"	0.844"	0.750"	1.08

NOTE: MACHINE SWAGE ONLY. DESIGNED TO MATE WITH S0733-SERIES SWAGE EYES (ABOVE).

SWAGE MARINE EYE



316 STAINLESS STEEL

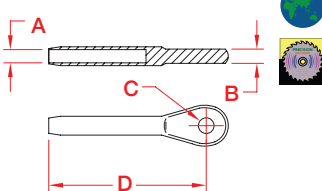

ITEM	A	B	C	D	BEFORE	AFTER	WT
	(wire)				(swage)	(swage)	(lb)
S0735-0001	1/16"	0.22"	0.26"	1.50"	0.160"	0.138"	0.03
S0735-0002	3/32"	0.22"	0.26"	1.76"	0.218"	0.190"	0.03
S0735-0003	1/8"	0.22"	0.26"	2.09"	0.250"	0.219"	0.04
S0735-0004	5/32"	0.28"	0.33"	2.36"	0.297"	0.250"	0.05
S0735-0005	3/16"	0.36"	0.39"	2.75"	0.359"	0.313"	0.09
S0735-0006	7/32"	0.41"	0.45"	3.22"	0.427"	0.375"	0.16
S0735-0007	1/4"	0.47"	0.51"	3.63"	0.494"	0.438"	0.23
S0735-0008	9/32"	0.47"	0.51"	3.80"	0.563"	0.500"	0.28
S0735-0009	5/16"	0.59"	0.64"	4.50"	0.635"	0.563"	0.45
S0735-0010	3/8"	0.59"	0.64"	4.93"	0.703"	0.625"	0.62
S0735-0013	1/2"	0.84"	0.89"	7.38"	0.844"	0.750"	1.14

NOTE: MACHINE SWAGE ONLY. FOR PROPER FUNCTIONING, OBSERVE CORRECT "AFTER" DIMENSIONS.

SWAGE MARINE JAW



316 STAINLESS STEEL

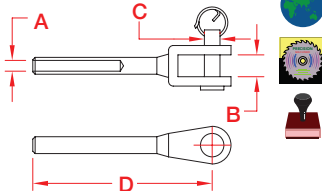

ITEM	A	B	C	D	BEFORE	AFTER	WT
	(wire)				(swage)	(swage)	(lb)
S0736-0001	1/16"	0.30"	0.19"	2.30"	0.160"	0.138"	0.03
S0736-0002	3/32"	0.30"	0.19"	2.30"	0.218"	0.190"	0.04
S0736-0003	1/8"	0.31"	0.19"	2.50"	0.250"	0.219"	0.04
S0736-0004	5/32"	0.39"	0.23"	2.90"	0.297"	0.250"	0.07
S0736-0005	3/16"	0.43"	0.31"	3.25"	0.359"	0.313"	0.11
S0736-0006	7/32"	0.49"	0.37"	3.72"	0.427"	0.375"	0.24
S0736-0007	1/4"	0.49"	0.43"	4.13"	0.494"	0.438"	0.29
S0736-0009	5/16"	0.56"	0.47"	5.08"	0.635"	0.563"	0.49
S0736-0010	3/8"	0.88"	0.55"	5.95"	0.703"	0.625"	0.78
S0736-0013	1/2"	0.94"	0.75"	8.18"	0.844"	0.750"	1.25

NOTE: MACHINE SWAGE ONLY. FOR PROPER FUNCTIONING, OBSERVE CORRECT "AFTER" DIMENSIONS.

SWAGE MARINE TOGGLE

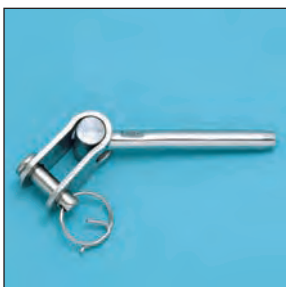

316 STAINLESS STEEL

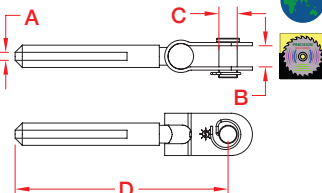

ITEM	A	B	C	D	BEFORE	AFTER	WT
	(size)				(swage)	(swage)	(lb)
S0737-0003	1/8"	0.38"	0.24"	2.78"	0.250"	0.219"	0.10
S0737-0004	5/32"	0.38"	0.24"	3.11"	0.297"	0.250"	0.16
S0737-0005	3/16"	0.39"	0.32"	3.70"	0.359"	0.313"	0.31
S0737-0006	7/32"	0.47"	0.39"	4.50"	0.427"	0.375"	0.34
S0737-0007	1/4"	0.47"	0.38"	4.49"	0.494"	0.438"	0.55
S0737-0008	9/32"	0.63"	0.47"	5.22"	0.563"	0.500"	0.68
S0737-0009	5/16"	0.63"	0.47"	5.53"	0.635"	0.563"	1.03
S0737-0010	3/8"	0.79"	0.63"	6.38"	0.703"	0.625"	2.20

NOTE: MACHINE SWAGE ONLY. FOR PROPER FUNCTIONING, OBSERVE CORRECT "AFTER" DIMENSIONS.

LIMITED LIFETIME WARRANTY

SUNCOR STAINLESS®

TEL 508-732-9191 • FAX 508-732-9798 • ORDERS ONLY 800-394-2222
www.suncorstainless.com

SWAGE DOMEHEAD

316 STAINLESS STEEL

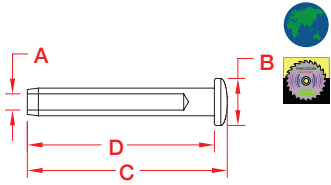

ITEM	A	B	C	D	BEFORE	AFTER	WT
	(size)				(swage)	(swage)	(lb)
S0738-0003	1/8"	0.39"	1.90"	1.77"	0.250"	0.219"	0.03
S0738-0004	5/32"	0.45"	2.18"	2.05"	0.297"	0.250"	0.04
S0738-0005	3/16"	0.55"	2.44"	2.28"	0.359"	0.313"	0.06
S0738-0007	1/4"	0.71"	2.99"	2.79"	0.494"	0.438"	0.14

NOTE:
MACHINE SWAGE REQUIRED. FOR PROPER FUNCTIONING,
OBSERVE CORRECT "AFTER" DIMENSIONS.

SWAGE STEMBALL

316 STAINLESS STEEL

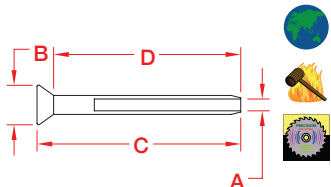

ITEM	A	B	C	D	BEFORE	AFTER	WT
	(wire)				(swage)	(swage)	(lb)
S0740-0003	1/8"	0.50"	2.28"	2.21"	0.250"	0.219"	0.03
S0740-0004	5/32"	0.61"	2.71"	2.48"	0.297"	0.250"	0.05
S0740-0005	3/16"	0.73"	3.08"	2.83"	0.359"	0.313"	0.08
S0740-0006	7/32"	0.77"	3.37"	3.11"	0.427"	0.375"	0.17
S0740-0007	1/4"	0.76"	3.52"	3.26"	0.494"	0.438"	0.17
S0740-0008	9/32"	0.81"	3.69"	3.43"	0.563"	0.500"	0.20
S0740-0009	5/16"	1.02"	4.60"	4.25"	0.635"	0.563"	0.35
S0740-0010	3/8"	1.04"	5.14"	4.68"	0.703"	0.625"	0.46

STEMBALL CUPS

S0741-0004	USE WITH S0740-0003, S0740-0004	0.04
S0741-0005	USE WITH S0740-0005	0.04
S0741-0007	USE WITH S0740-0006, S0740-0007	0.04
S0741-0010	USE WITH S0740-0009, S0740-0010	0.05

2 PART WIRE CLAMP/STOP

316 STAINLESS STEEL

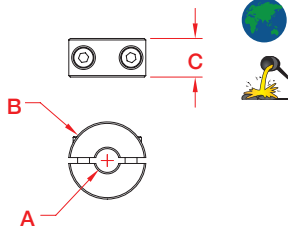

ITEM	A	B	C	WT
	(wire)			(lb)
S0720-0003	1/8"	0.64"	0.40"	0.02
S0720-0004	5/32"	0.64"	0.40"	0.03
S0720-0005	3/16"	0.79"	0.40"	0.04
S0720-0007	1/4"	0.79"	0.40"	0.05

NOTE:
CAN BE USED IN ARCHITECTURAL
FEATURES AS A WIRE CLAMP OR
IN SHELVING SYSTEMS AS A STOP
CLAMP. SIMPLE DESIGN OFFERS
A CLEAN, CONTEMPORARY LOOK.
PRODUCT SHOULD NEVER BE USED
IN LIFTING APPLICATIONS.



CROSS WIRE CLAMP

SURFACE MOUNT
316 STAINLESS STEEL

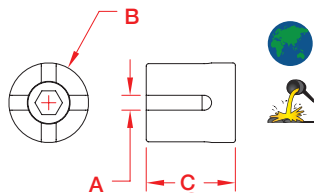

ITEM	A	B	C	WT
	(wire)			(lb)
S0722-0003	1/8"	0.67"	0.75"	0.06
S0722-0004	5/32"	0.79"	0.83"	0.07
S0722-0005	3/16"	0.79"	0.91"	0.08

NOTE:
MAY BE USED ONLY FOR WIRE ROPE
GUIDANCE PURPOSES (NOT AS AN
END CONNECTOR). CAN BE USED IN
ARCHITECTURAL APPLICATIONS
SUCH AS TRELLIS SYSTEMS OR
TO FORM WIRE NETTING. FITTING
CAN BE THREADED ON TO SURFACE
ANCHOR BOLT.



CROSS WIRE CLAMP

STANDARD
316 STAINLESS STEEL

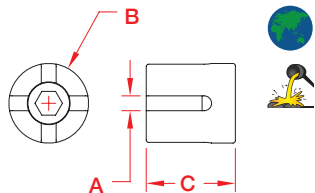

ITEM	A	B	C	WT
	(wire)			(lb)
S0721-0003	1/8"	0.67"	0.75"	0.07
S0721-0004	5/32"	0.79"	0.83"	0.08
S0721-0005	3/16"	0.79"	0.91"	0.09
S0721-0007	1/4"	0.79"	0.99"	0.11

NOTE:
MAY BE USED ONLY FOR WIRE ROPE
GUIDANCE PURPOSES (NOT AS AN
END CONNECTOR). CAN BE USED IN
ARCHITECTURAL APPLICATIONS
SUCH AS TRELLIS SYSTEMS OR
TO FORM WIRE NETTING.

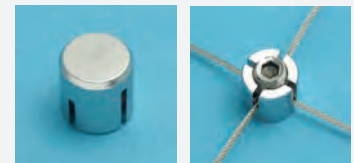

Key:

Made in USA	Drop Forged	Precision Machined	Wire Formed	Suncor Exclusive
Import	Precision Cast	Stamped	Load Rated	New Product

ORDERS ONLY: 800-394-2222
(USA+CANADA)

STOP SLEEVE

COPPER

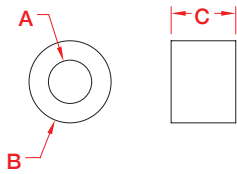
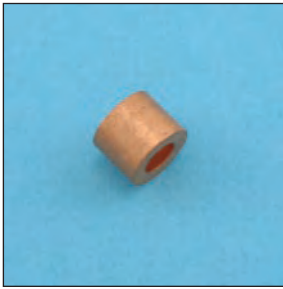

ITEM	A	B	C	HOLE#	WT	
	(wire")	(wire mm)			(lb)	
K0754-0001	1/16"	1.5 mm	0.20"	0.22"	1	0.002
K0754-0002	3/32"	2.5 mm	0.33"	0.32"	2	0.01
K0754-0003	1/8"	3.0 mm	0.33"	0.33"	3	0.01
K0754-0004	5/32"	4.0 mm	0.42"	0.33"	4	0.01
K0754-0005	3/16"	5.0 mm	0.42"	0.32"	5	0.01
K0754-0006	7/32"	5.5 mm	0.43"	0.63"	N/A	0.02
K0754-0007	1/4"	6.0 mm	0.66"	0.71"	1	0.06
K0754-0009	5/16"	8.0 mm	0.66"	0.71"	N/A	0.05
K0754-0010	3/8"	9.0 mm	0.66"	0.71"	N/A	0.04

NOTE:
SEE SWAGERS ON PAGE 53. FOR 1/16" - 1/8", USE E0113-0350.
FOR 1/16" - 3/16", USE E0113-0600. FOR 1/4" USE E0113-0700.
USE A HYDRAULIC SWAGER ON LARGER SIZES.

STOP SLEEVE

ALUMINUM

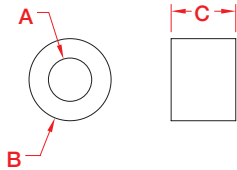

ITEM	A	B	C	HOLE#	WT	
	(wire")	(wire mm)			(lb)	
A0754-0001	1/16"	1.5 mm	0.20"	0.22"	1	0.001
A0754-0002	3/32"	2.5 mm	0.33"	0.32"	2	0.003
A0754-0003	1/8"	3.0 mm	0.33"	0.33"	3	0.002
A0754-0004	5/32"	4.0 mm	0.42"	0.33"	4	0.004
A0754-0005	3/16"	5.0 mm	0.42"	0.32"	5	0.004
A0754-0006	7/32"	5.5 mm	0.43"	0.63"	N/A	0.01
A0754-0007	1/4"	6.0 mm	0.66"	0.71"	1	0.02

NOTE:
SEE SWAGERS ON PAGE 53. FOR 1/16" - 1/8", USE E0113-0350.
FOR 1/16" - 3/16", USE E0113-0600. FOR 1/4" USE E0113-0700.
USE A HYDRAULIC SWAGER ON LARGER SIZES.

PLAIN BALL

316 STAINLESS STEEL

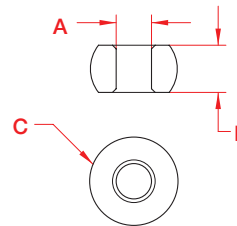

ITEM	A	B	C BEFORE	C AFTER	WT
	(wire)		(swage)	(swage)	(lb)
S0757-0000	1/32"	0.141"	0.211"	0.1905"	0.001
S0757-0001	3/64"	0.141"	0.211"	0.1905"	0.001
S0757-0002	1/16"	0.141"	0.211"	0.1905"	0.001
S0757-0003	3/32"	0.174"	0.288"	0.253"	0.002
S0757-0004	1/8"	0.190"	0.355"	0.317"	0.004
S0757-0005	5/32"	0.227"	0.429"	0.380"	0.006
S0757-0006	3/16"	0.264"	0.498"	0.442"	0.010
S0757-0007	7/32"	0.300"	0.557"	0.490"	0.015
S0757-0008	1/4"	0.335"	0.628"	0.559"	0.020

SINGLE SHANK BALL

316 STAINLESS STEEL

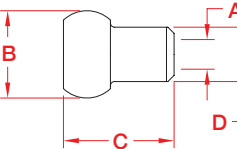

ITEM	A	B BEFORE	B AFTER	C	D BEFORE	D AFTER	WT
	(wire)	(swage)	(swage)		(swage)	(swage)	(lb)
S0755-0001	1/16"	0.21"	0.19"	0.27"	0.13"	0.11"	0.001
S0755-0002	3/32"	0.28"	0.25"	0.38"	0.17"	0.14"	0.003
S0755-0003	1/8"	0.35"	0.32"	0.50"	0.22"	0.19"	0.01
S0755-0004	5/32"	0.42"	0.38"	0.62"	0.26"	0.22"	0.01
S0755-0005	3/16"	0.49"	0.44"	0.73"	0.30"	0.26"	0.02
S0755-0006	7/32"	0.56"	0.51"	0.85"	0.35"	0.30"	0.02
S0755-0007	1/4"	0.63"	0.57"	0.96"	0.41"	0.35"	0.03
S0755-0009	5/16"	0.77"	0.69"	1.19"	0.48"	0.41"	0.06

DOUBLE SHANK BALL

316 STAINLESS STEEL

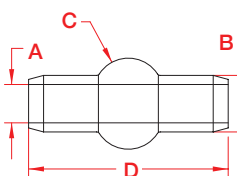

ITEM	A	B BEFORE	B AFTER	C BEFORE	C AFTER	D	WT
	(wire)	(swage)	(swage)	(swage)	(swage)		(lb)
S0756-0001	1/16"	0.13"	0.11"	0.21"	0.19"	0.36"	0.001
S0756-0002	3/32"	0.16"	0.14"	0.28"	0.25"	0.53"	0.003
S0756-0003	1/8"	0.22"	0.19"	0.35"	0.32"	0.69"	0.01
S0756-0004	5/32"	0.25"	0.22"	0.42"	0.38"	0.85"	0.01
S0756-0005	3/16"	0.29"	0.26"	0.49"	0.44"	1.01"	0.02
S0756-0006	7/32"	0.35"	0.30"	0.56"	0.51"	1.18"	0.03
S0756-0007	1/4"	0.40"	0.35"	0.62"	0.57"	1.34"	0.04
S0756-0009	5/16"	0.48"	0.41"	0.76"	0.69"	1.66"	0.07

LIMITED LIFETIME WARRANTY

SUNCOR STAINLESS®

TEL 508-732-9191 • FAX 508-732-9798 • ORDERS ONLY 800-394-2222
 www.suncorstainless.com

CYLINDRICAL TERMINAL

316 STAINLESS STEEL

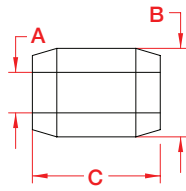

ITEM	SIZE	A	B BEFORE	B AFTER	C	WT
	(wire)		(swage)	(swage)		(lb)
S0758-0001	1/16"	0.076"	0.221"	0.190"	0.224"	0.002
S0758-0002	3/32"	0.107"	0.252"	0.219"	0.333"	0.004
S0758-0003	1/8"	0.146"	0.298"	0.250"	0.416"	0.006
S0758-0004	5/32"	0.177"	0.377"	0.313"	0.510"	0.011
S0758-0005	3/16"	0.208"	0.439"	0.375"	0.635"	0.020

SWAGE SLEEVE

316 STAINLESS STEEL

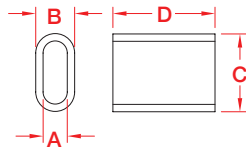

ITEM	A	B	C	D	AFTER SWAGE DIAMETER	WT
	(wire)					(lb)
S0750-0001	1/16"	0.139"	0.230"	0.375"	0.150"	0.001
S0750-0002	3/32"	0.166"	0.269"	0.375"	0.185"	0.002
S0750-0003	1/8"	0.234"	0.362"	0.379"	0.265"	0.003
S0750-0004	5/32"	0.320"	0.491"	0.723"	0.350"	0.01
S0750-0005	3/16"	0.355"	0.564"	0.876"	0.395"	0.01
S0750-0006	7/32"	0.432"	0.663"	0.885"	0.437"	0.01
S0750-0007	1/4"	0.457"	0.720"	1.131"	0.530"	0.01
S0750-0008	5/16"	0.781"	1.125"	1.594"	0.760"	0.03
S0750-0010*	3/8"	0.813"	1.125"	1.719"	0.760"	0.07
S0750-0016*	5/8"	1.250"	1.813"	2.719"	1.270"	0.69
S0750-0020*	3/4"	1.438"	2.125"	3.000"	1.530"	0.94
S0750-0025*	1"	2.000"	2.813"	3.750"	2.130"	2.28

* 300 STAINLESS STEEL

SWAGE SLEEVE

ALUMINUM

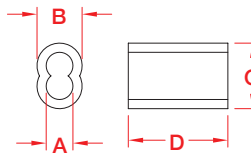

ITEM	A	B	C	D	CRIMPS	HOLE#
	(wire")	(wire mm)				
A0751-0001	1/16"	1.5 mm	0.185"	0.258"	0.390"	2
A0751-0002	3/32"	2.5 mm	0.277"	0.403"	0.490"	3
A0751-0003	1/8"	3.0 mm	0.336"	0.493"	0.628"	3
A0751-0004	5/32"	4.0 mm	0.381"	0.574"	0.686"	3
A0751-0005	3/16"	5.0 mm	0.443"	0.666"	1.004"	3
A0751-0007	1/4"	6.0 mm	0.536"	0.816"	1.137"	3
A0751-0009	5/16"	8.0 mm	0.689"	1.034"	1.245"	3
A0751-0010	3/8"	9.0 mm	0.752"	1.157"	1.447"	3
A0751-0013	1/2"	12.0 mm	1.054"	1.623"	2.000"	3

NOTE:
SEE SWAGERS ON PAGE 53. FOR 1/16" - 1/8", USE E0113-0350.
FOR 1/16" - 3/16", USE E0113-0600. FOR 1/4" USE E0113-0700.
USE A HYDRAULIC SWAGER ON LARGER SIZES.

SWAGE SLEEVE

COPPER

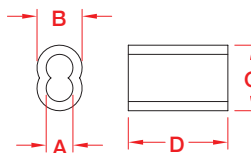

ITEM	A	B	C	D	CRIMPS	HOLE#
	(wire")	(wire mm)				
K0752-0001	1/16"	1.5 mm	0.169"	0.250"	0.372"	2
K0752-0002	3/32"	2.5 mm	0.224"	0.370"	0.400"	3
K0752-0003	1/8"	3.0 mm	0.327"	0.492"	0.554"	3
K0752-0004	5/32"	4.0 mm	0.369"	0.592"	0.606"	3
K0752-0005	3/16"	5.0 mm	0.450"	0.672"	0.940"	3
K0752-0007	1/4"	6.0 mm	0.515"	0.809"	1.110"	3
K0752-0009	5/16"	8.0 mm	0.668"	1.020"	1.051"	3
K0752-0010	3/8"	9.0 mm	0.728"	1.113"	1.236"	3
K0752-0013	1/2"	12.0 mm	0.955"	1.471"	1.892"	3

NOTE:
SEE SWAGERS ON PAGE 53. FOR 1/16" - 1/8", USE E0113-0350.
FOR 1/16" - 3/16", USE E0113-0600. FOR 1/4" USE E0113-0700.
USE A HYDRAULIC SWAGER ON LARGER SIZES.

SWAGE SLEEVE

ZINC PLATED COPPER

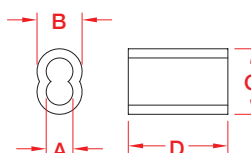

ITEM	A	B	C	D	CRIMPS	HOLE#
	(wire")	(wire mm)				
Z0753-0001	1/16"	1.5 mm	0.169"	0.250"	0.372"	2
Z0753-0002	3/32"	2.5 mm	0.224"	0.370"	0.400"	3
Z0753-0003	1/8"	3.0 mm	0.327"	0.492"	0.554"	3
Z0753-0004	5/32"	4.0 mm	0.369"	0.592"	0.606"	3
Z0753-0005	3/16"	5.0 mm	0.450"	0.672"	0.940"	3
Z0753-0006	7/32"	5.5 mm	0.460"	0.720"	0.860"	3
Z0753-0007	1/4"	6.0 mm	0.515"	0.809"	1.110"	3
Z0753-0009	5/16"	8.0 mm	0.668"	1.020"	1.051"	3
Z0753-0010	3/8"	9.0 mm	0.728"	1.113"	1.236"	3
Z0753-0013	1/2"	12.0 mm	0.955"	1.471"	1.892"	3

NOTE:
SEE SWAGERS ON PAGE 53. FOR 1/16" - 1/8", USE E0113-0350.
FOR 1/16" - 3/16", USE E0113-0600. FOR 1/4" USE E0113-0700.
USE A HYDRAULIC SWAGER ON LARGER SIZES.



Key:

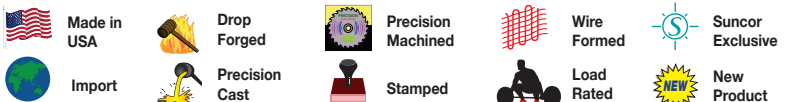

ORDERS ONLY: 800-394-2222 (USA+CANADA)

TOGGLE & HAND SWAGE STUD 316 STAINLESS STEEL

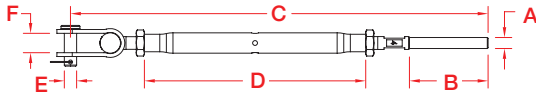

ITEM	A	B	C	D	E	F	WT
	(wire)						(lb)
S0782-H0703	1/8"	1.51"	8.02"	4.25"	0.24"	0.38"	0.21
S0782-H0705	3/16"	2.01"	8.64"	4.25"	0.24"	0.38"	0.24

NOTE:
DESIGNED FOR HAND SWAGE USE ONLY. THIS TURNBUCKLE FEATURES A CLOSED STYLE BODY WITH PRECISION MANUFACTURED END FITTINGS. ALL COMPONENTS ARE MADE FROM GRADE 316 STAINLESS STEEL.

CRIMP THE HAND SWAGE STUD ONTO THE WIRE ROPE USING THE HAND SWAGER (PART # E0113-H600, PAGE 43). USE HAND SWAGER HOLE #1 ON 1/8" WIRE AND HOLE #2 ON 3/16" WIRE.

HAND SWAGE

TOGGLE & HAND SWAGE STUD CHROMED BRONZE BODY & STAINLESS ENDS

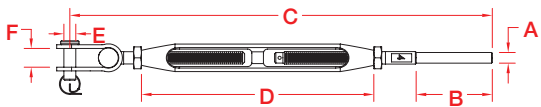

ITEM	A	B	C	D	E	F	WT
	(wire)						(lb)
S0786-H0703	1/8"	1.51"	8.38"	4.61"	0.24"	0.38"	0.25
S0786-H0705	3/16"	2.01"	9.00"	4.61"	0.24"	0.38"	0.28

NOTE:
DESIGNED FOR HAND SWAGE USE ONLY. MAKE INSTALLATION PAINLESS, USING SUNCOR'S HAND SWAGE LINE OF FITTINGS. THE OPEN BODY TURNBUCKLE COMBINES CHROMED BRONZE WITH GRADE 316 STAINLESS STEEL. ALSO AVAILABLE WITH SILICON BRONZE BODY.

CRIMP THE HAND SWAGE STUD ONTO THE WIRE ROPE USING THE HAND SWAGER (PART # E0113-H600, PAGE 43). USE HAND SWAGER HOLE #1 ON 1/8" WIRE AND HOLE #2 ON 3/16" WIRE.

HAND SWAGE

GATE EYE & HAND SWAGE STUD 316 STAINLESS STEEL

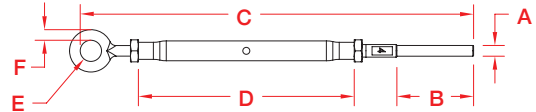

ITEM	A	B	C	D	E	F	WT
	(wire)						(lb)
S0794-H0703	1/8"	1.51"	7.75"	4.25"	0.42"	0.21"	0.21
S0794-H0705	3/16"	2.01"	8.37"	4.25"	0.42"	0.21"	0.23

NOTE:
DESIGNED FOR HAND SWAGE USE ONLY. THIS TURNBUCKLE FEATURES A CLOSED STYLE BODY WITH PRECISION MANUFACTURED END FITTINGS. ALL COMPONENTS ARE MADE FROM GRADE 316 STAINLESS STEEL.

CRIMP THE HAND SWAGE STUD ONTO THE WIRE ROPE USING THE HAND SWAGER (PART # E0113-H600, PAGE 43). USE HAND SWAGER HOLE #1 ON 1/8" WIRE AND HOLE #2 ON 3/16" WIRE.

HAND SWAGE

GATE EYE & HAND SWAGE STUD CHROMED BRONZE BODY & STAINLESS ENDS

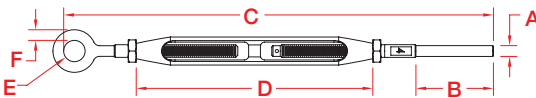

ITEM	A	B	C	D	E	F	WT
	(wire)						(lb)
S0795-H0703	1/8"	1.51"	8.38"	4.61"	0.42"	0.21"	0.25
S0795-H0705	3/16"	2.01"	9.00"	4.61"	0.42"	0.21"	0.27

NOTE:
DESIGNED FOR HAND SWAGE USE ONLY. MAKE INSTALLATION PAINLESS, USING SUNCOR'S HAND SWAGE LINE OF FITTINGS. THE OPEN BODY TURNBUCKLE COMBINES CHROMED BRONZE WITH GRADE 316 STAINLESS STEEL. ALSO AVAILABLE WITH SILICON BRONZE BODY.

CRIMP THE HAND SWAGE STUD ONTO THE WIRE ROPE USING THE HAND SWAGER (PART # E0113-H600, PAGE 43). USE HAND SWAGER HOLE #1 ON 1/8" WIRE AND HOLE #2 ON 3/16" WIRE.

HAND SWAGE

WALL MOUNT & HAND SWAGE STUD 316 STAINLESS STEEL

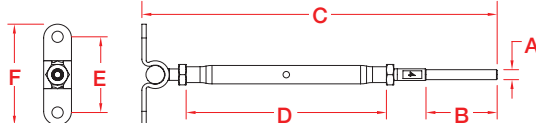

ITEM	A	B	C	D	E	F	WT
	(wire)						(lb)
S0784-H0703	1/8"	1.51"	7.54"	4.25"	1.62"	2.16"	0.21
S0784-H0705	3/16"	2.01"	8.16"	4.25"	1.62"	2.16"	0.23

NOTE:
DESIGNED FOR HAND SWAGE USE ONLY. THIS TURNBUCKLE FEATURES A CLOSED STYLE BODY WITH PRECISION MANUFACTURED END FITTINGS. ALL COMPONENTS ARE MADE FROM GRADE 316 STAINLESS STEEL.

CRIMP THE HAND SWAGE STUD ONTO THE WIRE ROPE USING THE HAND SWAGER (PART # E0113-H600, PAGE 43). USE HAND SWAGER HOLE #1 ON 1/8" WIRE AND HOLE #2 ON 3/16" WIRE.

REFERENCE "FASTENER MATCHING CHART" (PAGE 164) FOR COMPATIBLE FASTENERS.

HAND SWAGE

LIMITED LIFETIME WARRANTY

SUNCOR STAINLESS®

TEL 508-732-9191 • FAX 508-732-9798 • ORDERS ONLY 800-394-2222
www.suncorstainless.com

HAND SWAGE

HAND SWAGE

WALL MOUNT & HAND SWAGE STUD CHROMED BRONZE BODY & STAINLESS ENDS

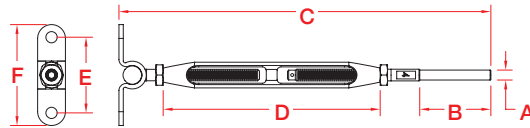

ITEM	A	B	C	D	E	F	WT
	(wire)						(lb)
S0798-H0703	1/8"	1.51"	7.90"	4.61"	1.62"	2.16"	0.24
S0798-H0705	3/16"	2.01"	8.52"	4.61"	1.62"	2.16"	0.26

NOTE:
DESIGNED FOR HAND SWAGE USE ONLY. MAKE INSTALLATION PAINLESS, USING SUNCOR'S HAND SWAGE LINE OF FITTINGS. THE OPEN BODY TURNBUCKLE COMBINES CHROMED BRONZE WITH GRADE 316 STAINLESS STEEL. ALSO AVAILABLE WITH SILICON BRONZE BODY.

CRIMP THE HAND SWAGE STUD ONTO THE WIRE ROPE USING THE HAND SWAGER (PART # E0113-H600, PAGE 43). USE HAND SWAGER HOLE #1 ON 1/8" WIRE AND HOLE #2 ON 3/16" WIRE.

REFERENCE "FASTENER MATCHING CHART" (PAGE 164-165) FOR COMPATIBLE FASTENERS.

HAND SWAGE

STUD & STUD - HAND SWAGE 316 STAINLESS STEEL

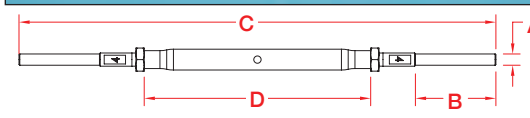

ITEM	A	B	C	D	WT
	(wire)				(lb)
S0796-H0703	1/8"	1.51"	8.95"	4.25"	0.17
S0796-H0705	3/16"	2.01"	10.19"	4.25"	0.21

NOTE:
DESIGNED FOR HAND SWAGE USE ONLY. THIS TURNBUCKLE FEATURES A CLOSED STYLE BODY WITH PRECISION MANUFACTURED END FITTINGS. ALL COMPONENTS ARE MADE FROM GRADE 316 STAINLESS STEEL.

CRIMP THE HAND SWAGE STUDS ONTO THE WIRE ROPE USING THE HAND SWAGER (PART # E0113-H600, PAGE 43). USE HAND SWAGER HOLE #1 ON 1/8" WIRE AND HOLE #2 ON 3/16" WIRE.

HAND SWAGE

STUD & STUD - HAND SWAGE CHROMED BRONZE BODY & STAINLESS ENDS

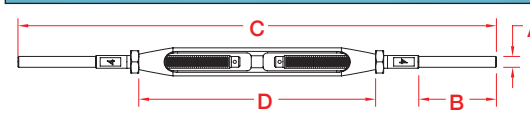

ITEM	A	B	C	D	WT
	(wire)				(lb)
S0797-H0703	1/8"	1.51"	9.31"	4.61"	0.20
S0797-H0705	3/16"	2.01"	10.53"	4.61"	0.24

NOTE:
DESIGNED FOR HAND SWAGE USE ONLY. MAKE INSTALLATION PAINLESS, USING SUNCOR'S HAND SWAGE LINE OF FITTINGS. THE OPEN BODY TURNBUCKLE COMBINES CHROMED BRONZE WITH GRADE 316 STAINLESS STEEL. ALSO AVAILABLE WITH SILICON BRONZE BODY.

CRIMP THE HAND SWAGE STUD ONTO THE WIRE ROPE USING THE HAND SWAGER (PART # E0113-H600, PAGE 43). USE HAND SWAGER HOLE #1 ON 1/8" WIRE AND HOLE #2 ON 3/16" WIRE.

HAND SWAGE

PELICAN HOOK W/ HAND SWAGE 316 STAINLESS STEEL

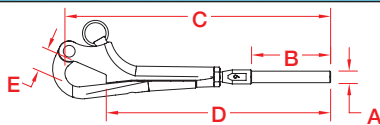

ITEM	A	B	C	D	E	WT
	(wire)					(lb)
S0162-H0703	1/8"	1.51"	5.13"	4.38"	0.59"	0.19
S0162-H0705	3/16"	2.01"	5.75"	5.00"	0.59"	0.22

NOTE:
DESIGNED FOR HAND SWAGE USE ONLY. MAKE INSTALLATIONS PAINLESS, USING SUNCOR'S HAND SWAGE LIFELINE FITTINGS. THIS HOOK FEATURES EASY OPENING CAPABILITIES. BODY AND SWAGE FITTING ARE MADE FROM GRADE 316 STAINLESS STEEL.

CRIMP THE HAND SWAGE STUDS ONTO THE WIRE ROPE USING THE HAND SWAGER (PART # E0113-H600, PAGE 43). USE HAND SWAGER HOLE #1 ON 1/8" WIRE AND HOLE #2 ON 3/16" WIRE.

HAND SWAGE

LIFELINE ADJUSTER W/ HAND SWAGE 316 STAINLESS STEEL

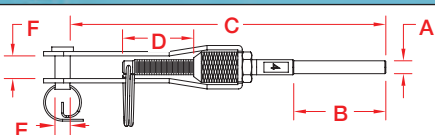

ITEM	A	B	C	D	E	F	WT
	(wire)						(lb)
S0745-H003	1/8"	1.51"	5.13"	1.19"	0.24"	0.42"	0.16
S0745-H005	3/16"	2.01"	5.77"	1.19"	0.24"	0.42"	0.18

NOTE:
DESIGNED FOR HAND SWAGE USE ONLY. MAKE INSTALLATIONS PAINLESS, USING SUNCOR'S HAND SWAGE LIFELINE FITTINGS. USE THIS ADJUSTER WHERE QUICK ADJUSTMENT IS REQUIRED WITHOUT THE USE OF TOOLS. BODY AND SWAGE FITTING ARE MADE FROM GRADE 316 STAINLESS STEEL.

CRIMP THE HAND SWAGE STUDS ONTO THE WIRE ROPE USING THE HAND SWAGER (PART # E0113-H600, PAGE 43). USE HAND SWAGER HOLE #1 ON 1/8" WIRE AND HOLE #2 ON 3/16" WIRE.

HAND SWAGE



Key:

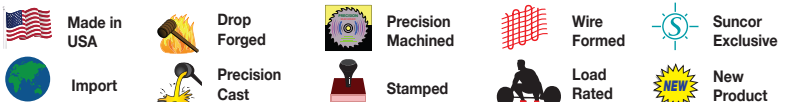

ORDERS ONLY: 800-394-2222 (USA+CANADA)

All logos, icons, images, measurements and descriptions are the sole property of Suncor Stainless, Inc. © 2020 Suncor Stainless, Inc.

GATE EYE - HAND SWAGE 316 STAINLESS STEEL

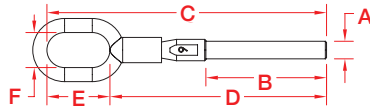

ITEM	A	B	C	D	E	F	WT
	(wire)						(lb)
S0744-H003	1/8"	1.51"	4.02"	2.97"	1.05"	0.59"	0.08
S0744-H005	3/16"	2.01"	4.66"	3.61"	1.05"	0.59"	0.11

NOTE:
DESIGNED FOR HAND SWAGE USE ONLY. MAKE INSTALLATIONS PAINLESS, USING SUNCOR'S HAND SWAGE LIFELINE FITTINGS. USE THE GATE EYE AT ONE END OF THE OPENING TO ATTACH THE PELICAN HOOK. EYE AND SWAGE FITTING ARE MADE FROM GRADE 316 STAINLESS STEEL.

CRIMP THE HAND SWAGE STUDS ONTO THE WIRE ROPE USING THE HAND SWAGER (PART # E0113-H600, PAGE 43). USE HAND SWAGER HOLE #1 ON 1/8" WIRE AND HOLE #2 ON 3/16" WIRE.

HAND SWAGE

JOINED GATE EYES - HAND SWAGE 316 STAINLESS STEEL

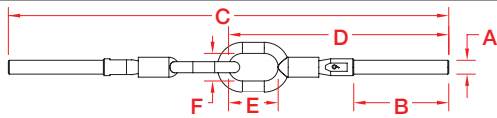

ITEM	A	B	C	D	E	F	WT
	(wire)						(lb)
S0746-H003	1/8"	1.51"	8.06"	4.02"	1.05"	0.59"	0.16
S0746-H005	3/16"	2.01"	9.32"	4.66"	1.05"	0.59"	0.21

NOTE:
DESIGNED FOR HAND SWAGE USE ONLY. MAKE INSTALLATIONS PAINLESS, USING SUNCOR'S HAND SWAGE LIFELINE FITTINGS. USE THE JOINED GATE EYES IN CONJUNCTION WITH THE SINGLE GATE EYE AT THE GATE OPENING IN THE LIFELINE. EYES AND SWAGE FITTINGS ARE MADE FROM GRADE 316 STAINLESS STEEL.

CRIMP THE HAND SWAGE STUDS ONTO THE WIRE ROPE USING THE HAND SWAGER (PART # E0113-H600, PAGE 43). USE HAND SWAGER HOLE #1 ON 1/8" WIRE AND HOLE #2 ON 3/16" WIRE.

HAND SWAGE

SWIVEL GATE EYE - HAND SWAGE 316 STAINLESS STEEL

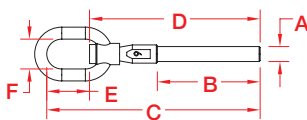

ITEM	A	B	C	D	E	F	WT
	(wire)						(lb)
S0718-H0703	1/8"	1.51"	3.53"	2.58"	0.84"	0.59"	0.08
S0718-H0705	3/16"	2.01"	4.17"	3.21"	0.84"	0.59"	0.10

NOTE:
DESIGNED FOR HAND SWAGE USE ONLY. MAKE INSTALLATIONS PAINLESS, USING SUNCOR'S HAND SWAGE LIFELINE FITTINGS. USE THE GATE EYE AT ONE END OF THE OPENING TO ATTACH THE PELICAN HOOK. EYE AND SWAGE FITTING ARE MADE FROM GRADE 316 STAINLESS STEEL.

CRIMP THE HAND SWAGE STUDS ONTO THE WIRE ROPE USING THE HAND SWAGER (PART # E0113-H600, PAGE 43). USE HAND SWAGER HOLE #1 ON 1/8" WIRE AND HOLE #2 ON 3/16" WIRE.

HAND SWAGE

JOINED SWIVEL GATE EYES - HAND SWAGE 316 STAINLESS STEEL

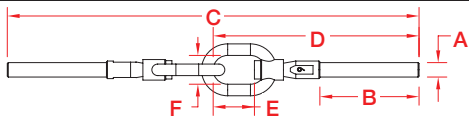

ITEM	A	B	C	D	E	F	WT
	(wire)						(lb)
S0719-H0703	1/8"	1.51"	7.09"	3.54"	0.84"	0.59"	0.15
S0719-H0705	3/16"	2.01"	8.35"	4.17"	0.84"	0.59"	0.19

NOTE:
DESIGNED FOR HAND SWAGE USE ONLY. MAKE INSTALLATIONS PAINLESS, USING SUNCOR'S HAND SWAGE LIFELINE FITTINGS. USE THE JOINED GATE EYES IN CONJUNCTION WITH THE SINGLE GATE EYE AT THE GATE OPENING IN THE LIFELINE. EYES AND SWAGE FITTINGS ARE MADE FROM GRADE 316 STAINLESS STEEL.

CRIMP THE HAND SWAGE STUDS ONTO THE WIRE ROPE USING THE HAND SWAGER (PART # E0113-H600, PAGE 43). USE HAND SWAGER HOLE #1 ON 1/8" WIRE AND HOLE #2 ON 3/16" WIRE.

HAND SWAGE

TOGGLE TERMINAL - HAND SWAGE 316 STAINLESS STEEL

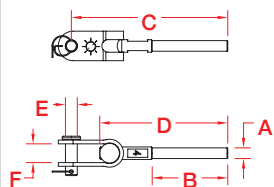

ITEM	A	B	C	D	E	F	WT
	(wire)						(lb)
S0737-H003	1/8"	1.51"	3.13"	2.56"	0.24"	0.38"	0.07
S0737-H005	3/16"	2.01"	3.80"	3.23"	0.24"	0.38"	0.10

NOTE:
DESIGNED FOR HAND SWAGE USE ONLY. MAKE INSTALLATION PAINLESS, USING SUNCOR'S HAND SWAGE LINE OF FITTINGS. THIS TOGGLE IS PERFECT FOR NUMEROUS MARINE, INDUSTRIAL AND ARCHITECTURAL APPLICATIONS. TOGGLE AND SWAGE FITTING ARE MADE FROM GRADE 316 STAINLESS STEEL.

CRIMP THE HAND SWAGE STUDS ONTO THE WIRE ROPE USING THE HAND SWAGER (PART # E0113-H600, PAGE 43). USE HAND SWAGER HOLE #1 ON 1/8" WIRE AND HOLE #2 ON 3/16" WIRE.

HAND SWAGE

LIMITED LIFETIME WARRANTY

SUNCOR STAINLESS®

TEL 508-732-9191 • FAX 508-732-9798 • ORDERS ONLY 800-394-2222
www.suncorstainless.com

HAND SWAGE

HAND SWAGE

WALL MOUNT TERMINAL - HAND SWAGE



316 STAINLESS STEEL

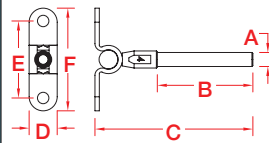

ITEM	A	B	C	D	E	F	WT
	(wire)						(lb)
S0723-H003	1/8"	1.51"	2.65"	0.59"	1.62"	2.16"	0.07
S0723-H005	3/16"	2.01"	3.32"	0.59"	1.62"	2.16"	0.09

NOTE:
DESIGNED FOR HAND SWAGE USE ONLY. THIS WALL MOUNTED SWAGE FITTING IS PERFECT FOR ARCHITECTURAL APPLICATIONS WHERE WIRE ROPE IS DESIRED. WALL MOUNT AND SWAGE FITTING ARE MADE FROM GRADE 316 STAINLESS STEEL.

CRIMP THE HAND SWAGE STUDS ONTO THE WIRE ROPE USING THE HAND SWAGER (PART # E0113-H600, PAGE 43). USE HAND SWAGER HOLE #1 ON 1/8" WIRE AND HOLE #2 ON 3/16" WIRE.

REFERENCE "FASTENER MATCHING CHART" (PAGE 164) FOR COMPATIBLE FASTENERS.

HAND SWAGE

SHORT STUD - HAND SWAGE

UNF - 316 STAINLESS STEEL

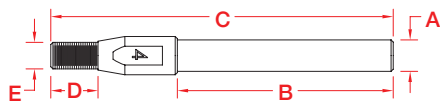

ITEM	A	B	C	D	E	WT
	(wire)				(thread)	(lb)
S0731-HM0703	1/8"	1.51"	2.56"	0.44"	0.25"	0.02
S0731-HM0705	3/16"	2.01"	3.19"	0.44"	0.25"	0.04

NOTE:
DESIGNED FOR HAND SWAGE USE ONLY. MAKE INSTALLATION PAINLESS, USING SUNCOR'S HAND SWAGE LINE OF FITTINGS. THREADS ARE "UNF".

CRIMP THE HAND SWAGE STUDS ONTO THE WIRE ROPE USING THE HAND SWAGER (PART # E0113-H600, PAGE 43). USE HAND SWAGER HOLE #1 ON 1/8" WIRE AND HOLE #2 ON 3/16" WIRE.

HAND SWAGE

STANDARD STUD - HAND SWAGE

UNF - 316 STAINLESS STEEL

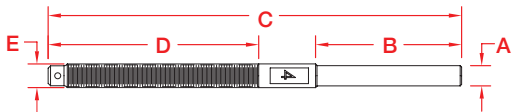

ITEM	A	B	C	D	E	WT
	(wire)				(thread)	(lb)
RIGHT HAND						
S0731-H0703	1/8"	1.51"	4.32"	2.20"	0.25"	0.04
S0731-H0705	3/16"	2.01"	4.94"	2.19"	0.25"	0.06
LEFT HAND						
S0732-H0703	1/8"	1.51"	4.32"	2.20"	0.25"	0.04
S0732-H0705	3/16"	2.01"	4.94"	2.19"	0.25"	0.06

NOTE:
DESIGNED FOR HAND SWAGE USE ONLY. MAKE INSTALLATION PAINLESS, USING SUNCOR'S HAND SWAGE LINE OF FITTINGS. THREADS ARE "UNF". CRIMP THE HAND SWAGE STUDS ONTO THE WIRE ROPE USING THE HAND SWAGER (PART # E0113-H600, PAGE 43). USE HAND SWAGER HOLE #1 ON 1/8" WIRE AND HOLE #2 ON 3/16" WIRE.

HAND SWAGE

EXTRA LONG STUD - HAND SWAGE

UNF - 316 STAINLESS STEEL

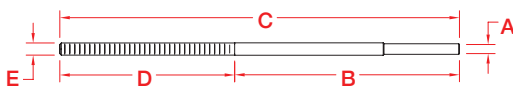

ITEM	A	B	C	D	E	WT
	(wire)				(thread)	(lb)
S0731-HL703	1/8"	4.50"	8.00"	3.50"	0.25"	0.09
S0731-HL705	3/16"	4.50"	8.00"	3.50"	0.25"	0.11

NOTE:
DESIGNED FOR HAND SWAGE USE ONLY. MAKE INSTALLATION PAINLESS, USING SUNCOR'S HAND SWAGE LINE OF FITTINGS. LONG STUD IS PERFECT FOR CABLE RAILING SYSTEMS WHERE "THROUGH POST" HARDWARE IS DESIRED FOR MINIMAL OBSTRUCTION.

THREADS ARE "UNF". CRIMP THE HAND SWAGE STUDS ONTO THE WIRE ROPE USING THE HAND SWAGER (PART # E0113-H600, PAGE 43). USE HAND SWAGER HOLE #1 ON 1/8" WIRE AND HOLE #2 ON 3/16" WIRE.

HAND SWAGE

STOP NUT

316 STAINLESS STEEL

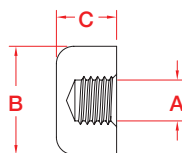

ITEM	A	B	C	THREAD	WT
	(size)				(lb)
UNC THREAD					
S0724-UN07-R	1/4"	0.75"	0.40"	Right Hand	0.03
S0724-UN07-L	1/4"	0.75"	0.40"	Left Hand	0.03
UNF THREAD					
S0724-UF07-R	1/4"	0.75"	0.40"	Right Hand	0.03
S0724-UF07-L	1/4"	0.75"	0.40"	Left Hand	0.03

NOTE:
DESIGNED FOR USE WITH HAND SWAGE AND STANDARD STUDS. STOP NUT IS PERFECT FOR CABLE RAILING SYSTEMS WHERE "THROUGH POST" HARDWARE IS DESIRED FOR MINIMAL OBSTRUCTION. USE AT THE END OF SWAGE STUDS FOR A FINISHED LOOK.

HAND SWAGE



ORDERS ONLY: 800-394-2222 (USA+CANADA)

Key:

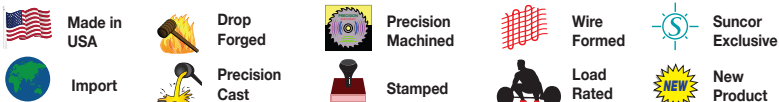

All logos, icons, images, measurements and descriptions are the sole property of Suncor Stainless, Inc. © 2020 Suncor Stainless, Inc.

COVER NUT - SET

316 STAINLESS STEEL

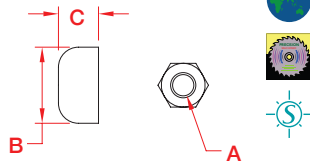

Cable Railing Hardware

Suncor Stainless offers a sleek design for architectural cable railing systems. Simply insert the long stud (S0731-HL Series, page 42) into a standard 4x4 post and affix the Cover Nut Set on the end and you're done! These items allow for a quick and easy installation and produce a unique alternative to a conventional railing system, featuring unobstructed views.



ITEM	A	B	C	THREAD	WT
	(size)				(lb)
UNC THREAD					
S0307-UN07-R	1/4"	0.75"	0.40"	Right Hand	0.04
S0307-UN07-L	1/4"	0.75"	0.40"	Left Hand	0.04
UNF THREAD					
S0307-UF07-R	1/4"	0.75"	0.40"	Right Hand	0.04
S0307-UF07-L	1/4"	0.75"	0.40"	Left Hand	0.04

NOTE:
DESIGNED FOR USE WITH HAND SWAGE AND STANDARD STUDS. COVER NUT SET IS PERFECT FOR CABLE RAILING SYSTEMS WHERE "THROUGH POST" HARDWARE IS DESIRED FOR MINIMAL OBSTRUCTION. AFFIX TO END OF SWAGE STUD FOR A FINISHED LOOK.

3 Easy Installation Steps



- Step 1**
Tighten nut to tension.
- Step 2**
Cut thread flush with nut.
- Step 3**
Install cap & you're done!

HAND SWAGE

ACORN NUT - SET

316 STAINLESS STEEL

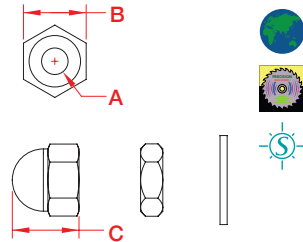

ITEM	A	B	C	THREAD	WT
	(size)				(lb)
UNF THREAD					
S0308-UF07-R	1/4"	0.44"	0.47"	Right Hand	0.02
S0308-UF07-L	1/4"	0.44"	0.47"	Left Hand	0.02

NOTE:
DESIGNED FOR USE WITH 1/4" THREAD HAND SWAGE AND STANDARD STUDS.

HAND SWAGE

"MINI" HAND SWAGER

*FOR USE WITH HAND SWAGE STUD SERIES

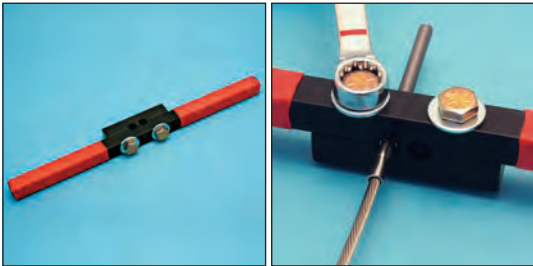

ITEM	SIZE	SWAGES	WT
	(length)		(lb)
E0113-H001	12"	1/8" and 3/16"	1.70

NOTE:
MAKE HAND SWAGING QUICK AND EASY USING SUNCOR'S "MINI" HAND SWAGER.

THE "MINI" HAND SWAGER CRIMPS THE HAND SWAGE STUDS ONTO THE WIRE ROPE. USE HOLE #1 ON 1/8" WIRE AND HOLE #2 ON 3/16" WIRE.

HAND SWAGE

HAND SWAGER

*FOR USE WITH HAND SWAGE STUD SERIES



ITEM	SIZE	SWAGES	WT
	(length)		(lb)
E0113-H600	24"	1/8", 5/32" and 3/16"	6.35

NOTE:
MAKE HAND SWAGING QUICK AND EASY USING SUNCOR'S HAND SWAGER. HAND SWAGER CRIMPS THE HAND SWAGE STUDS ONTO THE WIRE ROPE. FOR COMPATIBLE PRODUCTS, SEE PAGE 39-42.

HAND SWAGE

LIMITED LIFETIME WARRANTY

SUNCOR STAINLESS®

TEL 508-732-9191 • FAX 508-732-9798 • ORDERS ONLY 800-394-2222
www.suncorstainless.com