

CAPACITY (TONS)	INCHES	2-1/2	2-21/32	2-23/32	2-15/16	3-1/16	3-7/32	3-11/32	3-1/2	3-5/8	3-29/32	4-3/32	4-7/32	4-11/32	4-1/2	4-5/8	4-25/32	4-15/16	5-1/32	
	M.M.	64	67	69	75	78	82	85	89	92	99	104	107	110	114	117	121	125	128	
		← USE LOWER BAR PIN HOLE →										← USE UPPER LOAD BAR PIN HOLE →								
1/4, 1/2 and 1	SIDE #1	A	A	B	B	C	C	D	D	E	A	A	B	B	C	C	D	D	E	
	SIDE #2	A	B	B	C	C	D	D	E	E	A	B	B	C	C	D	D	E	E	

NOTE: Beam flange widths larger than those listed in these charts require special load bar (contact CM).

1/2 and 2 ton trolleys are supplied, respectively, with loose 1/4 and 1-1/2 ton capacity labels for those applications where lower capacity trolleys must be used. For such applications, remove the capacity label from the trolley side frame and replace it with the capacity label packed loose with the trolley.

CAPACITY (TONS)	INCHES	3-1/2	3-19/32	3-3/4	3-7/8	4	4-1/8	4-9/32	4-13/32	4-9/16	4-13/16	4-15/16	5-3/32	5-7/32	5-13/32	5-17/32	5-11/16	5-13/16	5-15/16	
	M.M.	89	91	95	98	102	105	109	112	116	122	125	129	133	140	144	148	151		
		← USE LOWER BAR PIN HOLE →										← USE UPPER LOAD BAR PIN HOLE →								
1-1/2 and 2	SIDE #1	A	A	B	B	C	C	D	D	E	A	A	B	B	C	C	D	D	E	
	SIDE #2	A	B	B	C	C	D	D	E	E	A	B	B	C	C	D	D	E	E	

CAPACITY (TONS)	BEAM FLANGE WIDTHS																	
	INCHES	3-29/32	4-1/16	4-3/16	4-11/32	4-1/2	4-21/32	4-25/32	4-29/32	5-1/4	5-13/32	5-17/32	5-11/16	5-27/32	5-31/32	6-1/8	6-9/32	6-7/16
M.M.	99	103	106	110	114	118	121	124	133	137	140	144	148	152	156	160	163	
		← USE LOWER BAR PIN HOLE →								← USE UPPER LOAD BAR PIN HOLE →								
3	SIDE #1	A	B	B	C	C	D	D	E	A	A	B	B	C	C	D	D	E
	SIDE #2	B	B	C	C	D	D	E	E	A	B	B	C	C	D	D	E	E

OPERATION

1. Observe trolley load capacity. Do not overload.
2. Place load directly under trolley. Avoid off-center and side loading of any kind.
3. Read the instructions contained on this sheet as well as ANSI B30.11 and the manual provided with the hoist or other appliance used with this trolley.

⚠ WARNING

TROLLEY MAY FALL FROM BEAM IF IMPROPERLY OPERATED.

TO AVOID INJURY:

- DO NOT OVERLOAD
- DO NOT SIDE LOAD

When ordering repair parts, specify the following:

1. Trolley capacity.
2. Key number and part number of the part required.
3. Part name.
4. Quantity required.
5. Beam size.

INSPECTION

Periodic trolley inspection should be carried out coincident with hoist (or other appliance) inspection. As a minimum, a monthly visual inspection of the load bar and trackwheels should be carried out. The load bar should be replaced when the observed wear exceeds 15% of the original stock dimension. Wheels should be removed from service when there is any visual indication of fracture at transition of flange and tread sections.

SERIES 632 TROLLEY PARTS LIST

KEY NO.	PART NUMBER				PART NAME	NO. REQ'D
	1/4 & 1/2 Ton	1 Ton	1-1/2 & 2 Ton	3 Ton		
632-1	32123	32124	32125	32671	Load Bar	1
632-2	32603	32604	32605	32672	Side frame assembly	2
632-3	32655	32655	32656	32673	Trackwheel assembly	4
632-4	32657	32658	32659	32674	Trackwheel screw with washer and nut	4
632-5	32660	32661	32682	32682	Adjusting collar with clevis pin & cotter pin	2
632-6	3227	3228	3229	—	Guard with set screw (optional)	1
632-7	32664	32665	32667	32675	Label kit (all labels for trolley) - not shown	1

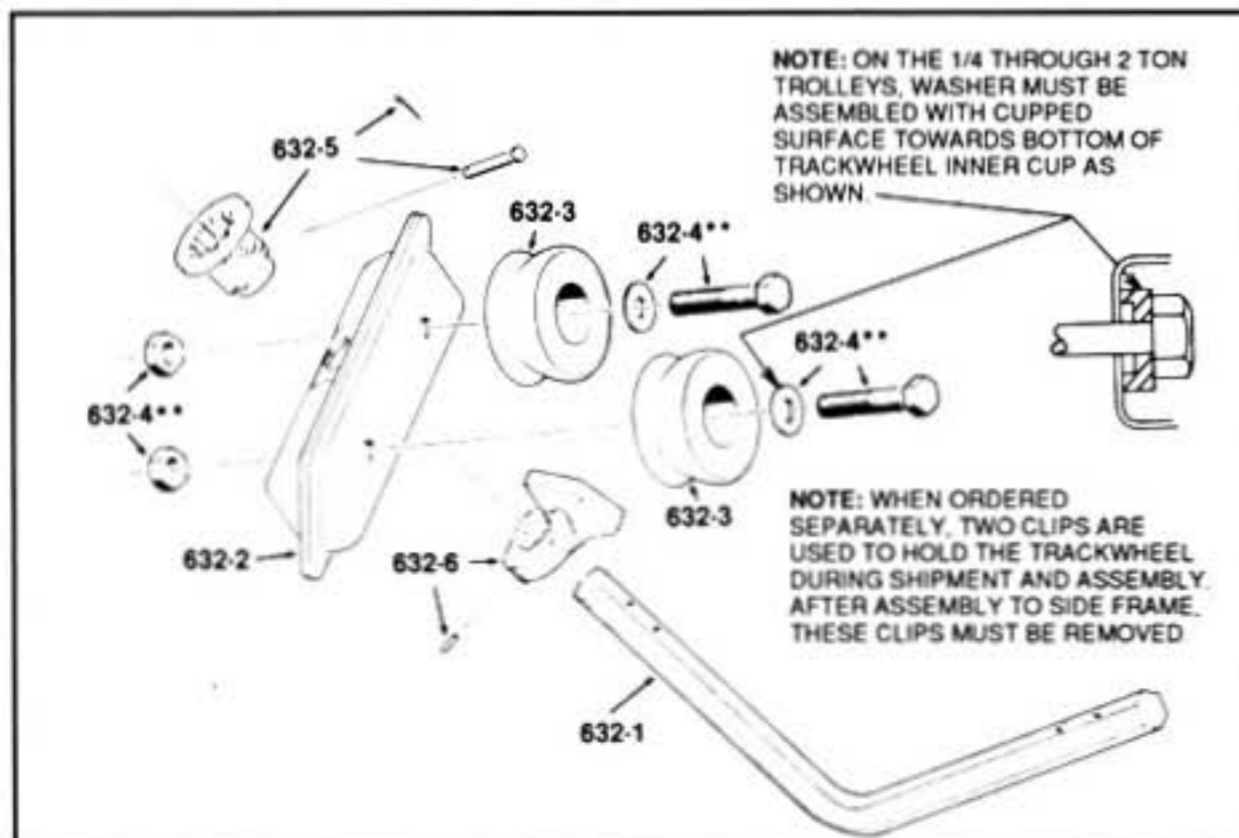

**

IMPORTANT: To avoid damage in use, threads on track wheel screw must not bear on side frame or track wheel, therefore, track wheel screw and nut must be assembled as shown with washer and head of screw inside track wheel.



COLUMBUS MCKINNON CORPORATION
INDUSTRIAL PRODUCTS DIVISION
140 JOHN JAMES AUDUBON PARKWAY
AMHERST, NEW YORK 14228-1197
716/689-5500 FAX: 716/689-5644