

# Carbon Anchor Shackles

**INDUSTRIAL/  
GOVERNMENT RATED**



**Screw Pin**



**Round Pin**



**Bolt, Nut & Cotter**

- Rated for overhead lifting
  - These shackles meet requirements of Federal Specification RR-C-271D Amendment 1, and ASME B30.26
  - All shackle pins are forged from alloy steel, heat treated and tempered to give greater strength
  - All shackles are marked with size (inches and millimeters) and working load limit in tons
  - Proof tested at 2.2 times the working load limit
  - Ultimate strength equals five times working load limit
  - All bolt, nut & cotter shackles have thread protected ends
  - Galvanized per ASTM A153
  - Standard industry tolerances apply
  - Do not exceed working load limit
  - When shackles need to be used above 400°F (204°C) or below -40°F (-140°C), consult factory
- \*Independent lab verified

## Specifications

Size	Working Load Limit	Product Code (Screw Pin)	Product Code (Round Pin)	Product Code (B,N & C)	P	E	W	R	L	B min	Weight
<b>Imperial</b>											
in.	Ton				in.	in.	in.	in.	in.	in.	lb.
3/16	1/3	MC645G	MC345G	-	0.250	0.307	0.375	0.625	0.875	0.562	0.06
1/4	1/2	MC646G	MC346G	MC846G	0.312	0.401	0.469	0.875	1.125	0.750	0.12
5/16	3/4	MC647G	MC347G	MC847G	0.375	0.463	0.531	1.000	1.250	0.812	0.20
3/8	1	MC648G	MC348G	MC848G	0.438	0.531	0.656	1.125	1.437	0.937	0.30
7/16	1-1/2	MC649G	MC349G	MC849G	0.500	0.593	0.750	1.250	1.689	1.062	0.50
1/2	2	MC650G	MC350G	MC850G	0.625	0.718	0.813	1.375	1.875	1.187	0.75
5/8	3-1/4	MC651G	MC351G	MC851G	0.750	0.843	1.063	1.875	2.375	1.500	1.30
3/4	4-3/4	MC652G	MC352G	MC852G	0.875	0.968	1.250	2.125	2.813	1.750	2.30
7/8	6-1/2	MC653G	MC353G	MC853G	1.000	1.109	1.438	2.375	3.312	2.000	3.50
1	8-1/2	MC654G	MC354G	MC854G	1.125	1.234	1.688	2.625	3.750	2.312	5.00
1-1/8	9-1/2	MC655G	MC355G	MC855G	1.250	1.375	1.812	2.875	4.250	2.625	7.00
1-1/4	12	MC656G	MC356G	MC856G	1.375	1.531	2.031	3.250	4.688	2.875	9.50
1-3/8	13-1/2	MC666G	MC366G	MC866G	1.500	1.656	2.250	3.500	5.250	3.250	12.50
1-1/2	17	MC657G	MC357G	MC857G	1.625	1.781	2.375	3.750	5.750	3.375	17.20
1-5/8	20	MC685G	MC385G	MC885G	1.750	1.906	2.625	4.125	6.250	4.000	23.50
1-3/4	25	MC677G	MC377G	MC877G	2.000	2.156	2.875	4.500	7.000	4.500	27.70
2	35	M658G	M358G	M858G	2.250	2.406	3.250	5.250	7.750	5.250	39.00

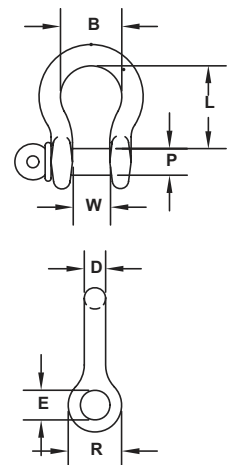

**Screw Pin**



**Round Pin**



**Bolt, Nut & Cotter**